

# OUMAN

## BUILDING AUTOMATION

### Price list

### 2024

**OUMAN**

Search

login | cart

**New product - Ouflex A XL!**

[Read more](#)

Have you already used?  
<https://oumanshop.com>

**The most popular products**

| Product          | Description  | Price     |
|------------------|--|-----------|
| A203             | Heating controller for three circuits, DIN rail mounting | 1485,00 € |
| OUMAN S202       | Surface mounted heating controller for three circuit     | 1504,00 € |
| OUMMA EH-800 10W | Intelligent heating controller for small homes           | 823,00 €  |
| OUFLEX A         | Compact programmable automation controller               | 1978,00 € |
| SH1A15           | Valve actuator, VDC controlled                           | 308,00 €  |



# Table of contents

## Unit prices

|   |    |
|---|----|
| Heating and air handling unit controllers ..... | 3  |
| GSM modems .....                                | 5  |
| Casing packages .....                           | 5  |
| Freely programmable automation units .....      | 6  |
| I/O Extension units.....                        | 6  |
| Building automation system topology .....       | 8  |
| Ouman Ounet .....                               | 10 |
| FT-Screen touch screen panels .....             | 10 |
| M-LINK interface converter .....                | 11 |
| Ouman 4G-internet product .....                 | 11 |
| Channel adapter cards .....                     | 11 |
| Casing solutions.....                           | 12 |
| Temperature sensors and room units .....        | 13 |
| Ouman wireless sensor system .....              | 15 |
| Energy meter and transmitters .....             | 16 |
| 2-way valves .....                              | 17 |
| 3-way valves .....                              | 22 |
| Connection sets .....                           | 26 |
| Valve adapters.....                             | 27 |
| Valve dimensioning table.....                   | 28 |
| Valves actuators, 3-point control .....         | 29 |
| Valve actuators, 0-10 V control .....           | 31 |
| Damper actuators.....                           | 33 |
| Other field devices.....                        | 36 |
| General Terms of Delivery and Warranty.....     | 38 |
| Contact details .....                           | 40 |

## PRODUCT CATEGORIES:



# Heating and air handling unit controllers

Price EUR  
Vat 0%

## EH-800 AND EH-800B HEATING CONTROLLER FOR SMALL HOMES

A new heating controller with one heating circuit, which is also possible to expand to have two heating circuits or alternatively to control two heating sources simultaneously. The controller can be used either with a home network or an internet web browser (not EH-800B). It is also possible to connect it to GSM.

With EH-800 it is delivered the heating controller and the actuator as a compact device, supply water sensor (TMS), outdoor temperature sensor with a plug-connection, power supply and the necessary adapter for the most common control valve (e.g. Termomix). It is possible also to order the adapters for Esbe VRG, VRB and Belimo R4-series valves. The controller is easy to install and use. It has 3 years warranty.



|                             |  |    |     |
|-----------------------------|--|----|-----|
| <b>EH-800</b><br>OMA0559    | Heating controller                         | B1 | 823 |
| <b>EH-800B</b><br>OMA0558   | Heating controller without Internet option | B1 | 722 |
| <b>SOV-ESBE2</b><br>OMA0266 | Adapter for Esbe VRG and VRB valves        | B1 | 31  |

## EXP-800 EXPANSION PACKAGE FOR THE EH-800 CONTROLLERS

Another heating circuit / for parallel control of another source of heat

Product package content: Pre-connected expansion unit, connecting cable, Belimo HTC24-SR valve engine, adapter for the most common mixing valve, TMS-3M surface temperature sensor and the introduction of the necessary instructions.



|                           |  |    |     |
|---------------------------|--|----|-----|
| <b>EXP-800</b><br>OMA0160 | Expansion package for the EH-800 controllers | B1 | 389 |
|---------------------------|--|----|-----|

## EXU-800 EXTERNAL UNIT FOR EH-800 AND EH-800B

External unit EXU-800 makes it possible to control a second valve actuator, another relay and also add two measurement information to the EH-800 heating controller.

EXU-800 product packaging containing the encapsulated control card, RJ45 cord and the coupling guide.



|                           |                                      |    |    |
|---------------------------|--------------------------------------|----|----|
| <b>EXU-800</b><br>OMA0161 | External unit for EH-800 and EH-800B | B1 | 85 |
|---------------------------|--------------------------------------|----|----|

## OPTIONAL EQUIPMENT

|                            |   |    |     |
|----------------------------|---|----|-----|
| <b>TMR</b><br>OMA0011      | Room sensor (NTC10)   | A1 | 48  |
| <b>TMR/SP</b><br>OMA0310   | Room sensor with fine-tuning knob                                   | A1 | 55  |
| <b>TMS-4M</b><br>OMA0321   | Surface sensor (NTC10), connection cable 4 m                        | A1 | 31  |
| <b>C01A</b><br>OMA0043     | Thermostat, surface mounting, 20 ... 90 °C, differential range 7 °C | A2 | 74  |
| <b>GSMMOD11</b><br>OMA0598 | OUUMAN GSM/GPRS -modem for EH-800                                   | C1 | 290 |

# Heating and air handling unit controllers

Price EUR  
Vat 0%

## OUMAN S203 HEATING CONTROLLER FOR THREE CIRCUITS

Ouman S203 is a new generation wall-mounted heating controller. Its versatility, intelligence and openness make it an ideal heating controller for all water circulation heating systems. Ouman S203 is really easy to use - informative display panel and GSM Control - feature enable reliable use anytime, anywhere. S203 can be connected to Ounet-service via Oulink-ETH-adapter (TCP/IP, optional) or other monitoring systems using a Modbus RTU.

- Operating voltage: 230 VAC, 50 Hz
- The internal 24 V power source, total load capacity of max. 1 A/23 VA
- Dimensions W230 x H160 x D60



|                         |  |    |      |
|-------------------------|--|----|------|
| <b>S203</b><br>OMA0253  | Heating controller for three circuits (2 heating circuits, 1 domestic hot water circuit) | A1 | 1504 |
| <b>RB-40</b><br>OMA0249 | External relay unit in casing, 4 pcs changeover relays (24V, 250VAC/16A), IP66           | A1 | 120  |

## OUMAN C203 HEATING CONTROLLER FOR THREE CIRCUITS

Ouman C203 is a new generation DIN-rail mounted heating controller. Its versatility, intelligence and openness make it an ideal heating controller for all water circulation heating systems. Ouman C203 is really easy to use - informative display panel and GSM Control - feature enable reliable use anytime, anywhere! C203 can be connected to Ounet-service via Oulink-ETH-adapter (TCP/IP, optional) or other monitoring systems using a Modbus RTU.

- Operating voltage: 230 VAC, 50 Hz
- The internal 24 V power source, total load capacity of max. 0.4A/10VA
- Dimensions W214 (13M) x H90 x D94



|                        |  |    |      |
|------------------------|--|----|------|
| <b>C203</b><br>OMA0044 | Heating controller for three circuits (2 heating circuits, 1 domestic hot water circuit)                                 | A1 | 1167 |
| <b>A203</b><br>OMA0650 | Heating controller for three circuits (2 heating circuits, 1 domestic hot water circuit)<br>Built in ethernet and WEB-UI | A1 | 1485 |

## OUMAN H23 HEATING CONTROLLER FOR THREE CIRCUITS

Ouman H23 is suitable for every house with central water heating. H23 is open to different types of remote monitoring solutions. House heating can now be monitored and controlled from the display of a GSM-phone, PC, and from the controller. Alarm messages can be received as text messages into a GSM-phone. H23 can be connected to Ounet-service via Oulink-ETH-adapter (TCP/IP, optional) or other monitoring systems using a Modbus RTU.

- Operating voltage: 230 VAC, 50 Hz
- The internal 24 V power source, total load capacity of max. 1A/23VA
- Dimensions W230 x H160 x D60
- Three switches on the cover for circulation pumps



|                       |  |    |      |
|-----------------------|--|----|------|
| <b>H23</b><br>OMA0180 | Heating controller for three circuits (2 heating circuits, 1 domestic hot water circuit) | A1 | 1379 |
|-----------------------|--|----|------|

## RU23 SCREEN UNIT FOR ROOM CONTROLLER

The Ouman RU23 room controller screen unit works with the programmable Ouflex product family. Not in direct sunlight. The device is intended for indoor installation.

- Capacitive 2.3" TFT touch screen
- Built-in 10K NTC sensor, external NTC sensor option
- IP20
- Dimensions 88x88x35. Mechanically designed to fit the common 55x55 frames (Schneider Exxact, Merten, Gira, Elko..)
- Operating voltage 12-40 VDC, power needs 0,5W
- Modbus RTU master/slave
- Operating temperature +5...+40°C



|                        |                                 |    |     |
|------------------------|---------------------------------|----|-----|
| <b>RU23</b><br>OMA0560 | Screen unit for room controller | A1 | 140 |
|------------------------|---------------------------------|----|-----|

# GSM modems

Price EUR  
Vat 0%

## OUMAN GSM MODEMS

Delivery includes GSM modem, DIN bracket, AC adapter, a separate power cable, data cable, and accessory bag attachment.



|                            |  |    |     |
|----------------------------|--|----|-----|
| <b>GSMMOD10</b><br>OMA0597 | OUMAN GSM/GPRS modem for EH-105 and EH-200 series controllers      | C1 | 290 |
| <b>GSMMOD11</b><br>OMA0598 | OUMAN GSM/GPRS modem for EH-800, Ouflex M and Ouflex C controllers | C1 | 290 |
| <b>GSMMOD12</b><br>OMA0599 | OUMAN GSM/GPRS modem for Ouman Plus and Ouman Ouflex               | C1 | 309 |

## ANT1 EXTERNAL ANTENNA

- Magnet antenna
- Antenna cable 2,5 m, interface FME
- Antenna extension cable ANT-C-10M, see page 9.



|                        |                                       |    |    |
|------------------------|---------------------------------------|----|----|
| <b>ANT1</b><br>OMA0035 | External antenna for Ouman GSM-modeem | C1 | 41 |
|------------------------|---------------------------------------|----|----|

# Casing packages

## K118 CASING PACKAGE, 18 MODULES

Contents:

- casing (enclosure rating IP 54), 1 x 18 modules, size: 403 x 333 x 129 [mm]
- transformer (230/24 VAC, capacity 10 VA)
- master switch



|                       |  |    |     |
|-----------------------|--|----|-----|
| <b>K118</b><br>OMA189 | Casing package 18 modules (one DIN rail) | C2 | 150 |
|-----------------------|--|----|-----|

## K212 CASING PACKAGE, 24 MODULES

Contents:

- casing (enclosure rating IP54); 12 + 3 modules, size: 295 x 457 x 129 [mm]
- transformer (230 / 24 VAC, capacity 40 VA)
- master switch

|                        |   |    |     |
|------------------------|---|----|-----|
| <b>K212</b><br>OMA0190 | Casing package 24 modules (two DIN rails) | C2 | 153 |
|------------------------|---|----|-----|

## K218 CASING PACKAGE, 36 MODULES

Contents:

- casing (enclosure rating IP 54), 2 x 18 modules, size: 403 x 483 x 129 [mm]
- transformer (230/24 VAC, capacity 40 VA)
- master switch



|                        |   |    |     |
|------------------------|---|----|-----|
| <b>K218</b><br>OMA0192 | Casing package 36 modules (two DIN rails) | C2 | 224 |
|------------------------|---|----|-----|

## K312 CASING PACKAGE, 36 MODULES

Contents:

- casing (enclosure rating IP54); 12 + 12 + 2 modules, size: 295 x 457 x 129 [mm]
- transformer (230 / 24 VAC, capacity 63 VA)
- master switch

|                        |   |    |     |
|------------------------|---|----|-----|
| <b>K312</b><br>OMA0193 | Casing package 36 modules (three DIN rails) | C2 | 202 |
|------------------------|---|----|-----|

## K318 CASING PACKAGE, 54 MODULES

Contents:

- casing (enclosure rating IP54); 18 + 12 + 11 modules, size: 403 x 630 x 129 [mm]
- transformer 24 VAC, capacity 63 VA, 12 VDC 24W
- master switch

|                        |   |    |     |
|------------------------|---|----|-----|
| <b>K318</b><br>OMA0194 | Casing package 54 modules (three DIN rails) | C2 | 295 |
|------------------------|---|----|-----|

## K412 CASING PACKAGE, 48 MODULES

Contents:

- casing (enclosure rating IP54); 12 + 12 + 12 + 2 modules, size: 665 x 295 x 129 [mm]
- transformer 230 / 24 VAC, capacity 63 VA
- master switch

|                        |   |    |     |
|------------------------|---|----|-----|
| <b>K412</b><br>OMA0553 | Casing package 48 modules (three DIN rails) | C2 | 275 |
|------------------------|---|----|-----|



# Freely programmable automation units

Price EUR  
Vat 0%

## OUMAN OUFLEX A FREELY PROGRAMMABLE AUTOMATION UNIT

Ouflex A is a freely programmable and DIN-rail-attachable building automation system for control and monitoring. Ouflex A includes 34 I/O-points, and also versatile data transfer and field bus connections. In addition, the device contains 24 VAC and 15 VDC outputs. Display unit is detachable, and can be relocated. It is possible to increase the number of I/O-points with external I/O-modules via bus connections. The DIN-standard-compatible structure of the Ouflex A device enables installation to most common cabinets. Detachable strip connectors make installation easier.



Dimensions: width 214 mm (13M),  
height 90 mm, depth 94 mm

### Ouflex A I/O-points

- 16 pcs universal measurements (UI)
- 2 pcs digital inputs (DI)
- 6 pcs 0...10V analog outputs (AO)
- 2 pcs change-over contact relays (DO)
- 4 pcs normally open contact relays (DO)
- 4 pcs 24 VAC Triac-outputs (TR)

### Data transfer connections

- 3 pcs RS-485 bus connections
- USB-host-connection
- Ethernet

### Operating voltage

- 24 VAC, 50 Hz

**Access-functionality option is built-in to the all Ouflex-devices. Activation as an option.**

Ouman Access is flexible way to get remote connection to the automation device. Access can use internet connection that already exists in the building. That's why internet connection is immediately ready to use. Access remote connection is device-specific and the service is available the whole life cycle of the automation device.

|                               |  |    |      |
|-------------------------------|--|----|------|
| <b>OUFLEX A</b><br>OMA0518    | Freely programmable automation unit  | A1 | 1978 |
| <b>OUFLEX A XL</b><br>OMA0634 | A more efficient and faster version compared to. Ouflex A. Program capacity +50%. Same I/O points. | A1 | 2334 |

## OPTIONS

|  |                                    |    |     |
|--|------------------------------------|----|-----|
| <b>GSMMOD12</b><br>OMA0599             | OUMAN GSM/GPRS -modem for Ouflex.  | C1 | 309 |
| <b>OUMAN LCD FRAME GREY</b><br>OMA0519 | Wall installation frame for Ouflex | C1 | 33  |
| <b>OUMAN LCD GREY</b><br>OMA0658       | Display for Ouflex                 | A1 | 135 |

## OUMAN OUFLEX M BA FREELY PROGRAMMABLE AUTOMATION UNIT

Operating voltage 24 VAC or 24 VDC, local display 132 x 64 px.

### Ouflex M BA I/O points

- 15 pcs. universal inputs (UI)
- 4 pcs. 0...10 V analog outputs (AO)
- 6 pcs. relay outputs NO, 230V 5A
- 1 PWM output (heating control)

### Data transfer connections

- 2 pcs. RS-485 bus
- 2 pcs. RS-232 bus
- 1 USB device
- Ethernet with M-LINK



|   |                                     |    |     |
|---|-------------------------------------|----|-----|
| <b>OUFLEX M BA</b><br>OMA0496           | Freely programmable automation unit | A1 | 978 |
| <b>OUFLEX M LCD KIT GREY</b><br>OMA0527 | Ouflex M LCD with cable and frame   | A1 | 184 |

## I/O-EXTENSION UNITS

I/O-extension units are used to increase I/O capacity of the Ouflex device. Units are DIN-rail attachable and possible to connect to bus. They are easy to decentralize as needed. I/O-extension units have the necessary 24 VAC power supply connectors for field devices.

### Operating voltage

- 24 VAC, 50 Hz



Measurements: width 213,5 mm  
(13M), height 90 mm, depth 93,3 mm

|                                 |   |   |    |     |
|---------------------------------|---|---|----|-----|
| <b>FLEX COMBI 32</b><br>OMA0526 | 16 pcs universal inputs (UI)<br>6 pcs 0...10V analog outputs (AO) | 2 pcs change-over contact relays (DO)<br>4 pcs normally open contact relays (DO)<br>4 pcs 24 VAC Triac-outputs (TR) | A1 | 782 |
| <b>FLEX COMBI 21</b><br>OMA0524 | 9 pcs universal inputs (UI)<br>2 pcs 0...10V analog outputs (AO)  | 2 pcs change-over contact relays (DO)<br>4 pcs normally open contact relays (DO)<br>4 pcs 24 VAC Triac-outputs (TR) | A1 | 519 |
| <b>FLEX UI 16</b><br>OMA0523    | 16 pcs universal inputs (UI)                                      |   | A1 | 343 |



**FLEX UI8** is a DIN-rail-attachable Modbus RTU input module which can be connected to RS-485 bus. It has 8 configurable universal inputs.

**Supported signals and sensor types are:**

- Transmitters 0-10 V or 0/4-20 mA
- Supported passive sensors: NTC10, NTC1.8, NTC2.2 ja NTC20 Ni 1000 LG, Ni 1000 DIN 43760, Pt 1000
- Potential free digital contact
- Potential free pulse counter (min 30ms)

Operating voltage: 24 VAC/VDC (-10%...+20%), 50/60 Hz

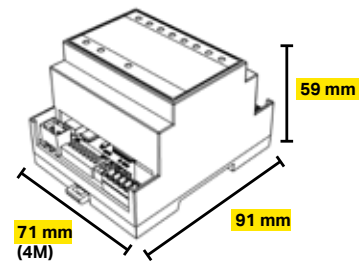

**FLEX A08** is a DIN-rail-attachable Modbus RTU output module which can be connected to RS-485 bus. It has 8 analog outputs.

- Output voltage range 0...10V
- Output current max. 7mA/output
- Each output has AUTO-MANUAL switch.
- Manual position is controlled via potentiometer in each channel separately

Operating voltage: 24 VAC/VDC (-10%...+20%), 50/60 Hz

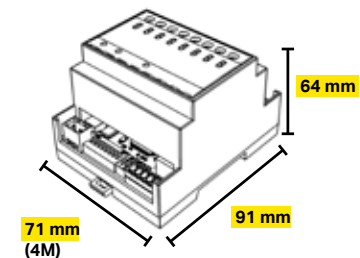

**FLEX D04-R** is a DIN-rail-attachable Modbus RTU relay unit which can be connected to RS-485 bus. It has 4 relay controls.

- In each relay control it is possible to choose either the automatic control or forced ON or OFF control (ON - AUTO- OFF).
- Change-over contact relay 230 VAC/ 4A or 24 VDC/4A
- Easy to install in electrical cabinet

Operating voltage: 24 VAC/VDC (-10%...+20%), 50/60 Hz

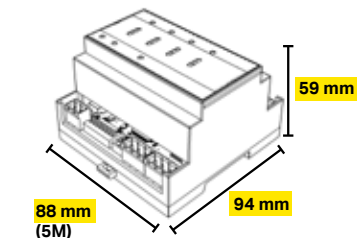

**FLEX D04-TRS** is a DIN-rail-attachable Modbus RTU triac module which can be connected to RS-485 bus. It has 4 AC triac switches.

- Each triac control has 3 stage switch for selection between automatic control, forced ON or OFF (ON - AUTO - OFF).
- 24...230VAC, max 1A/output
- Potential-free AC switch
- DC controls require a supplementary relay in installation

Operating voltage: 24 VAC/VDC (-10%...+20%), 50/60 Hz

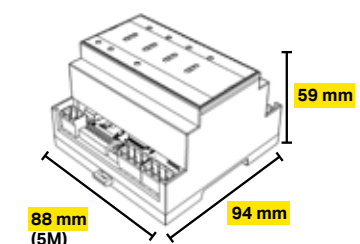

|                                |                         |    |     |
|--------------------------------|-------------------------|----|-----|
| <b>FLEX UI8</b><br>OMAO471     | Universal input module  | A1 | 315 |
| <b>FLEX A08</b><br>OMAO472     | Universal output module | A1 | 277 |
| <b>FLEX D04-R</b><br>OMAO473   | Universal relay module  | A1 | 227 |
| <b>FLEX D04-TRS</b><br>OMAO474 | Universal triac module  | A1 | 214 |

# Building automation system topology

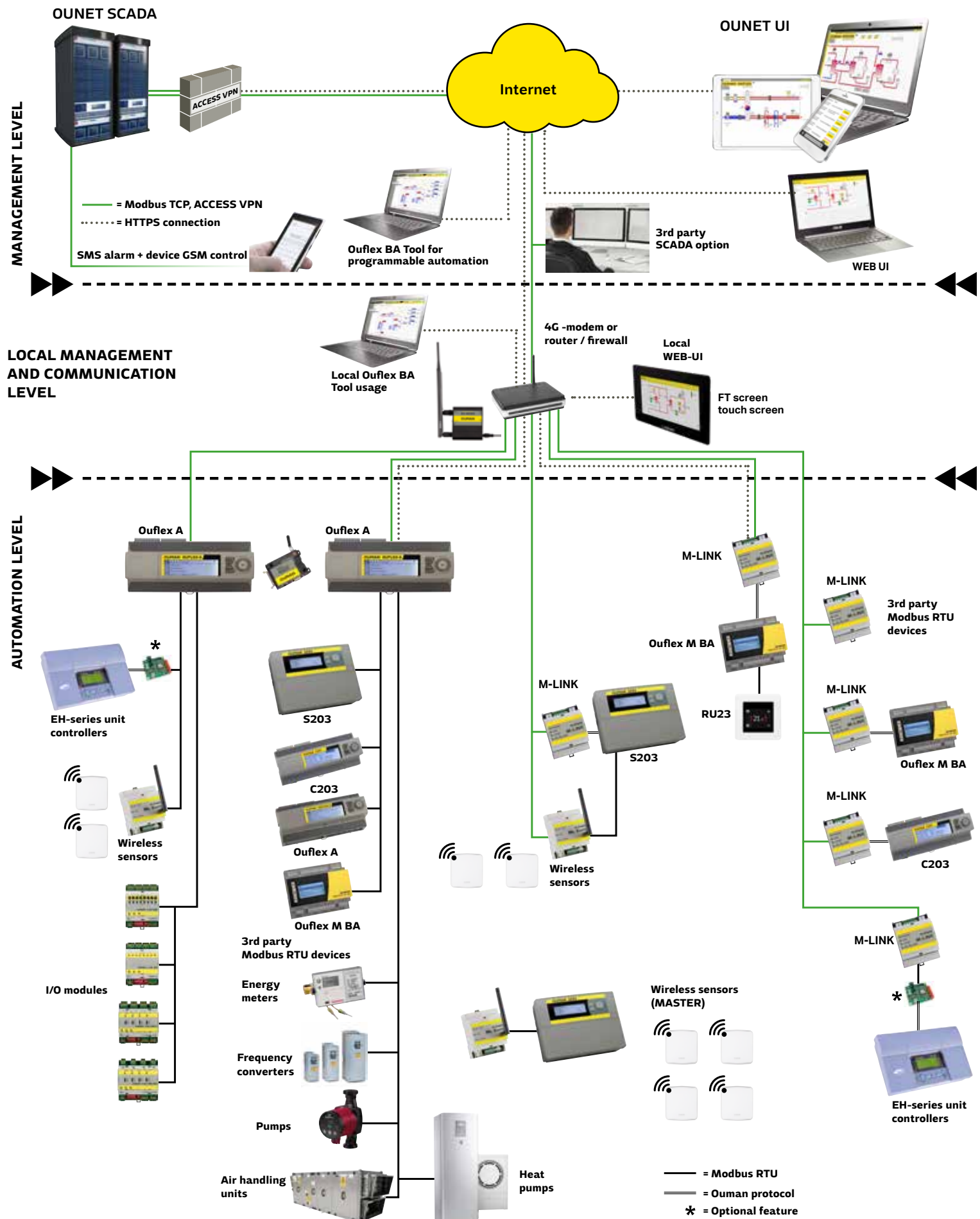



# Ouman system components

MANAGEMENT LEVEL



## Ouman Access server

- Secure VPN connection
- Plug & play connectivity
- Including name server (DHCP)
- Creating easy access and secure connection to devices.
- Customer register functionality for OEMs offers capability to connect devices securely to internet and gives possibility to create own solution based web interface for specific service



## Ouflex BA Tool

- Uses secure VPN connection to devices in the field
- Remote plug & play connection to devices
- Upload/download of applications
- Online process monitoring
- Automatic updates
- Free trial for 14 days
- Software license available on demand for certified users



OUNET browser UI (HTML5)

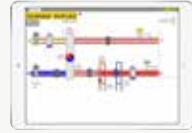

OUNET in mobile or tablet (HTML5)



## OUNET SCADA solution in cloud service

- Cloud solution offers maintenance free usage
- Use your OUNET from any location by using web browser
- Only one login is needed to access all your facilities/targets
- Enables easy process management and system fine tuning
- Alarm routing by using email and SMS. Also alarm groups available.
- Target calendar with diary function for easy follow up of tasks
- Trend data is stored to cloud for further analysis and reports
- Flexible report generation for all stored trend data
- Automated report sending to selected receivers

LOCAL MANAGEMENT AND COMMUNICATION LEVEL



## 4G-MOD2

- Compact and meets industry level requirements
- Easy installation
- Optional external antenna available
- Suitable for any operator SIM card which supports mobile data connection



## 2G GSM SMS Modem

- Compact and meets industry level requirements
- Easy installation
- Optional external antenna available
- SMS alarm and device GSM control via SMS



## FT screen touch screen

- Can be used for ounet.fi or local WEB UI browsing
- Capacitive touch screen
- Available in size 7", 10" and 15"

AUTOMATION LEVEL

## Ouflex A



## Programmable controller platforms

- Three device platforms available (A,C and M)
- Platform specific template available in Ouflex Tool library
- Easy and fast forward programming with ready made library components
- Built-in Access and TCP/IP modbus -with C and M platforms M-LINK device is required
- Remote device management
- Read/Write functions trough controller gateway
- Easy to connect new Modbus devices (TCP/IP and RTU)
- External display available for C & M platforms – A platform comes with detachable display



Ouflex M BA

## Ouflex I/O modules

- These I/O modules can be used to expand controller IO capabilities
- Modules are compatible with any systems supporting Modbus RTU
- UI8 is configurable input module with resistive sensors, digital contacts, pulse counters and transmitters with voltage and mA outputs
- AO8 is analog output module with 8 pcs of 0-10V outputs. Selection between automatic and manual state with switches.
- DO4-R module includes four bistable relays.
- DO4-TRS is module with four triac switches from 24VAC up to 240VAC



## S203



## C203

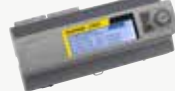

## OUMAN unit controllers

- New generation controllers based on Ouflex platform
- Built-in Modbus RTU bus
- Easy configuration with setup wizard
- Software version can be updated by using SD memory card
- With OULINK device optional Modbus TCP/IP connection and Access VPN functionality for secure connection and easy integration to OUNET SCADA system.

## Ouman Wireless

- Easy and fast installation
- Any browser can be used to access base station data
- Good radio coverage with 868Mhz mesh network
- Built-in secure Access VPN functionality in WL-base
- Sensors can be used as routers with external power supply
- Sensors are providing temperature, humidity and additional auxiliary measurement
- Sensors are powered with standard AA batteries
- Modbus TCP/IP and RTU communication
- Intelligent calculation of collected data in base station
- Automated average calculation of measurements e.g. for heating curve optimization



## M-LINK



## M-LINK – new model with more functions

- Can be used similarly like previous Oulink model
- Provides remote tool management for C & M platforms
- Modbus TCP/IP to Modbus RTU gateway converter for any 3th party RTU slave device
- OPC UA communication protocol

## 3rd party Modbus RTU devices



Heat pumps



Energy meters



Pumps



Air handling units



Frequency converters

## OUNET WEB BASED SCADA FOR BUILDING AUTOMATION

Ounet is a modern web-based SCADA for building automation. It enables fluent control of technical building services from any location and whenever needed. Ounet provides effective, easy-to-use tools for property management and maintains the appropriate conditions.

|              |   |                                    |
|--------------|---|------------------------------------|
| <b>OUNET</b> | Web based SCADA for building automation | <b>222/year/target/1500 points</b> |
|--------------|---|------------------------------------|



## Technical details

|                                 |   |
|---------------------------------|---|
| <b>Languages:</b>               | Finnish, English, Swedish, Estonian             |
| <b>Technology:</b>              | HTML5   |
| <b>Browsers:</b>                | Internet Explorer/Edge, Chrome, Firefox, Safari |
| <b>Alarm forwarding:</b>        | SMS and email                                   |
| <b>Address:</b>                 | www.ounet.fi                                    |
| <b>Customer devices</b>         |   |
| <b>Operating systems:</b>       | Windows, Android, IOS, Linux                    |
| <b>Recommended screen size:</b> | 3,2" and larger                                 |
| <b>Screen technology:</b>       | Passive screens or touchscreens                 |
| <b>Display modes:</b>           | Mobile and desktop                              |

## FT-Screen touch screen panels

- Cutout installation, fits to covers and doors, IP65
- Capacitive Android touch screen
- Can be used for browsing ounet.fi or local WEB UI



|                                      |  |    |        |
|--------------------------------------|--|----|--------|
| <b>FT-SCREEN 7</b><br>OMB0523        | iSMA-D-PA7C-B1-EU 7" capacitive touch screen     | C2 | 590**  |
| <b>FT-SCREEN 10</b><br>OMB0517       | iSMA-D-PA10C-B1-EU 10.1" capacitive touch screen | C2 | 962**  |
| <b>FT-SCREEN 15</b><br>OMB0519       | iSMA-D-PA15C-B1-EU 15.6" capacitive touch screen | C2 | 1166** |
| <b>FT-SCREEN 10 FRAME</b><br>OMA0640 | Surface mounting frame for 10" touch screen      | C2 | 30     |

# M-LINK interface converter

Price EUR  
Vat 0%

The M-LINK interface converter can be used to connect Ouman controllers and 3rd party equipment via the RTU interface to the Ounet SCADA solution. Device can be also used to convert Modbus RTU protocol to Modbus TCP/IP protocol. This enables connectivity to other SCADA systems by using Modbus TCP/IP protocol. Maximum quantity of connected RTU devices is 10 units.

By connecting device to internet connection, secure VPN connection is established between M-LINK device and Ounet SCADA solution. VPN connection is built up by using OUMAN Access solution, which is secure M2M connection, which is provided for all OUMAN devices using internet connection.

If local area network connection does not exist, device can be connected to internet by using the 4G-MOD1 Modem.

Internal WEB-server enables easy connectivity to OUMAN unit controllers. For example S203, C203, H23, EH-203 and EH-105 controllers can be configured by using ready made templates which can be selected from M-LINK WEB-server interface. Server can also provide point transfer between devices within same IP network and buffering of trend data. With OUFLEX TOOL server can be programmed to use Modbus description files to be used for 3rd party devices.

M-LINK can be connected to one OUMAN controller through C-serial RJ45 connector and this enables updating of applications for example to OUFLEX M BA unit.



## Communication protocols:

- Modbus RTU
- Modbus TCP / IP

|                          |  |           |     |
|--------------------------|--|-----------|-----|
| <b>M-LINK</b><br>OMAO443 | Interface converter with ACCESS-function | <b>A1</b> | 683 |
|--------------------------|--|-----------|-----|

# Ouman 4G-internet product

## WIRELESS 4G-COMMUNICATION

4G-MOD1 is a wireless connection to Access -devices or for their verification. You can buy the subscription from your preferred operator.

|                           |          |           |     |
|---------------------------|----------|-----------|-----|
| <b>4G-MOD2</b><br>OMA0654 | 4G-modem | <b>C1</b> | 309 |
|---------------------------|----------|-----------|-----|

## ADDITIONAL PRODUCTS

|                             |  |           |     |
|-----------------------------|--|-----------|-----|
| <b>ANT2</b><br>OMB0009      | Omnidirectional 3G-antena with 8 meter cable     | <b>C1</b> | 210 |
| <b>ANT-C-10M</b><br>OMB0012 | 10 meter extension cable for GSM- and 3G-antenna | <b>C1</b> | 54  |

# Channel adapter cards and converters

## MODBUS AND EH-485 CHANNEL ADAPTER CARDS

Modbus- and EH-485 cards are channel adapter cards with which controllers traffic route are made to be compatible with an Modbus or RS-485 field channel.



|                              |   |           |     |
|------------------------------|---|-----------|-----|
| <b>MODBUS-100</b><br>OMA0208 | Modbus adapter card for EH-105 controller | <b>A1</b> | 182 |
| <b>MODBUS-200</b><br>OMA0003 | Modbus adapter card for EH-200 controller | <b>A1</b> | 182 |

## M-BUS/MODBUS converters

|                                  |  |           |     |
|----------------------------------|--|-----------|-----|
| <b>MBUS-MODBUS-2</b><br>OMB0509  | M-Bus/Modbus converter (max. 2 devices)  | <b>C2</b> | 213 |
| <b>MBUS-MODBUS-8</b><br>OMB0510  | M-Bus/Modbus converter (max. 8 devices)  | <b>C2</b> | 266 |
| <b>MBUS-MODBUS-80</b><br>OMB0511 | M-Bus/Modbus converter (max. 80 devices) | <b>C2</b> | 550 |

**LM1-HC 4G** Remote monitoring solution for unit controllers  
(Ouman C203, S203 and EH-203)

- Content:
- M-LINK interface converter pre programmed for Ounet remote control and monitoring, room compensation also included
  - Space reservation for WL-Base gateway unit
  - 4G modem
  - Casing package with power supply
  - Ounet SCADA setup



**NOTE!**

- WL-Base and wireless sensors are sold separately
- Ounet contract is not included
- 4G-L3 subscription isnot included

|                             |   |           |      |
|-----------------------------|---|-----------|------|
| <b>LM1-HC 4G</b><br>OMA0540 | Remote monitoring solution for unit controllers | <b>A1</b> | 1481 |
|-----------------------------|---|-----------|------|

# Temperature sensors and room units

Price EUR  
Vat 0%

## TMO OUTDOOR SENSOR

Outdoor sensor measures the outside air temperature. The sensor color is white-gray, so the measuring difference caused by solar radiation is as small as possible. The sensor comes with a cable gland.



NTC10: For Ouman controllers  
Pt1000: For Danfoss and Honeywell controllers  
Ni1000LG: For Siemens controllers

|                       |                |    | NTC10 | Pt1000 | Ni1000LG |
|-----------------------|----------------|----|-------|--------|----------|
| <b>TMO</b><br>OMAO015 | Outdoor sensor | A1 | 33    | 35     | 41       |

## ROOM SENSORS

The room sensor can be used with Ouman air handling unit controller EH-105 as well as the EH-200 and EH-800 series heating controllers. Position the room sensor so that it measures the facility's average temperature.

TMR/SP is equipped with temperature measurements and fine-tuning knob. It can change the EH-105 and EH-800 equipment room temperature setpoint -5 ... 4 °C.



|                          |   |    | NTC10 | Pt1000 | Ni1000LG |
|--------------------------|---|----|-------|--------|----------|
| <b>TMR</b><br>OMAO011    | Room sensor                                       | A1 | 48    | 55     | 67       |
| <b>TMR/SP</b><br>OMAO310 | Huonolämpötila-anturi kaukoasetuspotentiometrillä | A1 | 55    |        |          |

## TMS SURFACE SENSOR

The surface sensor is used to measure the temperature of the liquid flowing in the pipe. The sensor is installed on the surface of the pipe with a fastening strap. Suitable for pipe sizes DN 20...80.



|                               |                                      |    | NTC10 | Pt1000 | Ni1000LG |
|-------------------------------|--------------------------------------|----|-------|--------|----------|
| <b>TMS</b><br>OMAO312         | Surface sensor                       | A1 | 27    | -      | -        |
| <b>TMS-C/NTC10</b><br>OMAO497 | Surface sensor with connector, NTC10 | A1 | 25    | -      | -        |
| <b>TMS-2M</b><br>OMAO016      | Surface sensor, connection cable 2 m | A1 | 28    | 45     | 52       |
| <b>TMS-3M</b><br>OMAO318      | Surface sensor, connection cable 3 m | A1 | 29    | -      | -        |
| <b>TMS-4M</b><br>OMAO321      | Surface sensor, connection cable 4 m | A1 | 31    | 46     | 55       |

## TMW-C CONNECTION CABLES

|  |  |    |    |
|--|--|----|----|
| <b>TMW-C KYTKENTÄ KAAPELI 2 M</b><br>OMAO516 | 2m connection cable for temperature sensors with connector | A1 | 14 |
| <b>TMW-C KYTKENTÄ KAAPELI 3 M</b><br>OMAO626 | 3m connection cable for temperature sensors with connector | A1 | 17 |



# Temperature sensors

Price EUR  
Vat 0%

## TMW WATER SENSOR

The water sensors installed on the water pipes are suitable for heating and domestic hot water control. Sensors are made of stainless steel (AISI 304), but the TMW-300 sensor's thread nipple is made of brass. Sensors come with immersion tube of different lengths as follows (Ø 4 mm). TMW-50, -100 and -210 are suitable for pressure class PN16 and TMW-300 for PN10.



NTC10: For Ouman controllers

Pt1000: For Danfoss and Honeywell controllers

Ni1000LG: For Siemens controllers

|                           |   |    | NTC10 | Pt1000 | Ni1000LG |
|---------------------------|---|----|-------|--------|----------|
| <b>TMW-50</b><br>OMA0012  | Water sensor, 50 mm, thread R1/2"               | A1 | 57    | 67     | 74       |
| <b>TMW-100</b><br>OMA0013 | Water sensor, 100 mm, thread R1/2"              | A1 | 58    | 75     | 75       |
| <b>TMW-210</b><br>OMA0340 | Water sensor, 210 mm, thread R1/2"              | A1 | 61    | 71     | 77       |
| <b>TMW-300</b><br>OMA0343 | Water sensor, 300 mm (adjustable), thread R1/2" | A1 | 64    | 83     | 92       |



|                                   |   |    |    |  |  |
|-----------------------------------|---|----|----|--|--|
| <b>TMW-50-C/NTC10</b><br>OMA0499  | Water sensor with connector, 50 mm, thread R1/2"  | A1 | 46 |  |  |
| <b>TMW-100-C/NTC10</b><br>OMA0500 | Water sensor with connector, 100 mm, thread R1/2" | A1 | 48 |  |  |
| <b>TMW-210-C/NTC10</b><br>OMA0501 | Water sensor with connector, 210 mm, thread R1/2" | A1 | 50 |  |  |

## TMW-ST WATER SENSOR WITH PROTECTIVE POCKET

The water sensors installed on the water pipes are suitable for heating and domestic hot water control (also with aggressive water). Immersion tubes are made of stainless steel (AISI 304) and the thread nipple is made of same material. Sensor's tube is a diameter of 4 mm and protection tube 5 mm. Sensors are suitable for pressure class PN16.



|                             |   |    | NTC10 | Pt1000 | Ni1000LG |
|-----------------------------|---|----|-------|--------|----------|
| <b>TMW-81ST</b><br>OMA0352  | Water sensor and protection pocket 80 mm, thread R1/2"  | A1 | 107   | 128    | 112      |
| <b>TMW-121ST</b><br>OMA0330 | Water sensor and protection pocket 120 mm, thread R1/2" | A1 | 88    | 108    | 112      |
| <b>TMW-201ST</b><br>OMA0337 | Water sensor and protection pocket 200 mm, thread R1/2" | A1 | 96    | 106    | 110      |

## TMI ICE FROST SENSOR

Ice frost sensors are used to measure the air conditioning ice frost function and return water regulation temperature. The sensor is made of stainless steel (AISI 304). A sensor has 2 m long immersion pipe, which has a diameter of 4 mm.



|                       |                          |    | NTC10 | Pt1000 | Ni1000LG |
|-----------------------|--------------------------|----|-------|--------|----------|
| <b>TMI</b><br>OMA0293 | Ice frost sensor, R 1/4" | A1 | 58    | 76     | 80       |

## TMD DUCT SENSOR

Duct sensor is used for air conditioning duct temperature measurements. Brassy protection tube has a diameter of 8 mm and a length of 250 mm.



|                       |             |    | NTC10 | Pt1000 | Ni1000LG |
|-----------------------|-------------|----|-------|--------|----------|
| <b>TMD</b><br>OMA0014 | Duct sensor | A1 | 46    | 55     | 65       |

## PTL-10 WATER PRESSURE SENSOR

- Operating voltage 15-24 VDC / 24 VAC (+/-10%)
- Output 0-10V
- Thread G1/4, includes adapter G1/4-G1/2
- IP 65



|                            |                       |    |  |     |  |
|----------------------------|-----------------------|----|--|-----|--|
| <b>PTL-10-V</b><br>OMBO470 | Water pressure sensor | A2 |  | 188 |  |
|----------------------------|-----------------------|----|--|-----|--|

# Ouman wireless sensor system

Price EUR  
Vat 0%

The wireless Ouman sensor system enables quick and easy collection of precise room temperature data in a building without laborious laying of cables and drilling of walls. The sensor system comprises a gateway unit, wireless sensors in router mode that are connected to the mains, and battery-operated wireless sensors. A predefined description file makes it easy to connect the wireless sensors to a SCADA system. In the event of failure, a damaged sensor can be replaced without changing the template file. This makes the installation of the replacement sensor quicker and easier.

## WL-BASE GATEWAY UNIT

- Linux based
- Access feature
- Built-in Web server to facilitate installation
- Separate installation mode with a short 10 s. measurement interval
- Measurement interval freely adjustable (1-240 min)
- Ethernet, Modbus TCP/IP
- RS-485, Modbus



## WL-TEMP-RH 2.1 WIRELESS TEMPERATURE AND HUMIDITY SENSOR

- Built-in antenna
- 2 x AA batteries (does not include)
- In addition to serving as a measuring sensor, the same antenna also serves a router if mains (5-12V DC, 20 mA)
- Measuring accuracy  $\pm 0.2^{\circ}\text{C}$  (the same as Ouman controllers)
- Operating temperature:  $0-50^{\circ}\text{C}$
- Thanks to advanced system circuit the covering range of the sensors is not impaired when the battery is low.
- 868 MHz Mesh technology
- Connector for outdoor temperature sensor (with a fixed cable connection to outside)



|  |  |           |     |
|--|--|-----------|-----|
| <b>WL-BASE 2.1</b><br>OMA0489          | Gateway unit   | <b>A1</b> | 437 |
| <b>WL-TEMP-RH 2.1</b><br>OMA0579       | Wireless temperature and humidity sensor   | <b>A1</b> | 130 |
| <b>WL-SOCKET-ROUTER 2.1</b><br>OMA0582 | Fixed mounting router in staircase (on top of the present electric socket)             | <b>A1</b> | 224 |
| <b>WL-TEMP-RH-WHIP 2.1</b><br>OMA0583  | Wireless temperature and humidity sensor with 1.8m whip sensor                         | <b>A1</b> | 239 |
| <b>WL-TEMP-RH-CO2 2.1</b><br>OMA0584   | Wireless temperature and humidity sensor with CO2 measuring. Needs outer power source. | <b>A1</b> | 324 |
| <b>WL-TEMP-RH-VOC 2.1</b><br>OMA0585   | Wireless temperature and humidity sensor with VOC measuring. Needs outer power source. | <b>A1</b> | 317 |
| <b>WL-TEMP-RH-PD</b><br>OMA0587        | Wireless temperature and humidity sensor with pressure difference measuring.           | <b>A1</b> | 281 |
| <b>WL-ROUTER POWER</b><br>OMA0430      | Power unit for temperature sensor 5 VDC (needed when operating as a router)            | <b>A1</b> | 24  |
| <b>WL-BASE-POWER</b><br>OMA0448        | Power unit for WL-Base, 24 VDC plug  | <b>C1</b> | 35  |
| <b>WL-ANT</b><br>OMB0473               | Antenna for WL-Base, 4m cable, magnetic fixing   | <b>C1</b> | 41  |
| <b>WL-BATTERY-AA-LIT</b><br>OMB0472    | Battery package for wireless temperature sensors. Includes 10 pcs. AA lithium          |           | 24  |

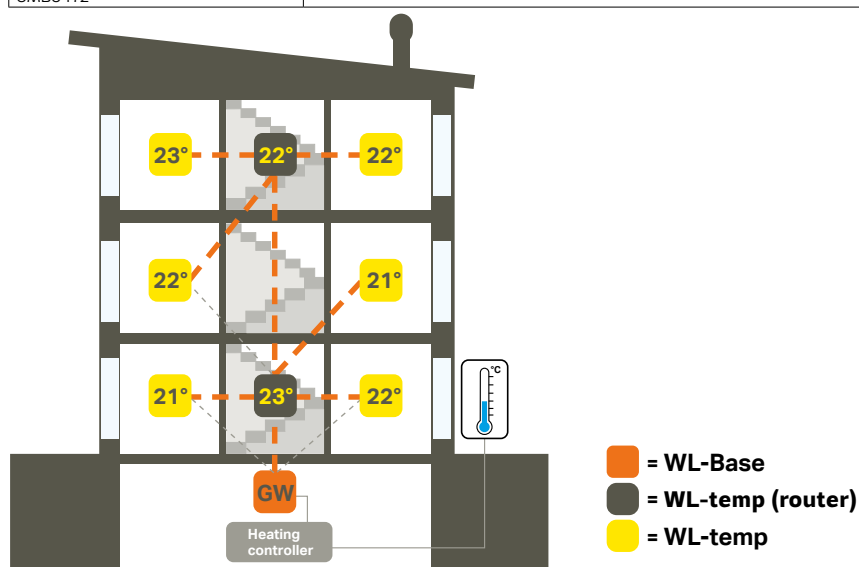

! no stock product

# Energy meter and transmitters

Price EUR  
Vat 0%

## DPT DIFFERENTIAL PRESSURE TRANSMITTER

The DPT is an electronic differential pressure transmitter used for measuring low pressures of air and non-aggressive gasses in order to monitor and control pressures in building automation, HVAC and clean room systems. Measuring range can be selected from -100 Pa and 2500 Pa between. Transmitter has an automatic reset.



|                         |  |    |     |
|-------------------------|--|----|-----|
| <b>DPT</b><br>OMB0033   | Differential pressure transmitter              | A1 | 210 |
| <b>DPT/D</b><br>OMB0035 | Differential pressure transmitter with display | A1 | 243 |

## PDI PRESSURE DIFFERENCE MANOMETER, IP 54

- Measuring range 0 - 600 Pa
- Operating temperature -40°C...+60°C



|                       |   |    |     |
|-----------------------|---|----|-----|
| <b>PDI</b><br>OMB0298 | Pressure difference manometer MM 200600 | A2 | 119 |
|-----------------------|---|----|-----|

## PDS PRESSURE DIFFERENCE SWITCH, IP 54

- Different measuring ranges
- Connection difference 30 Pa
- Operating temperature -20°C...+60°C



|                                    |  |    |    |
|------------------------------------|--|----|----|
| <b>!</b> <b>PDS-300</b><br>OMB0310 | Pressure difference switch, 40 - 600 Pa, PS600 | A2 | 37 |
| <b>PDS-600</b><br>OMB0301          | Pressure difference switch, 40 - 600 Pa, PS600 | A2 | 37 |

## PRESSURE TRANSMITTER FOR WATER



|                                       |   |    |     |
|---------------------------------------|---|----|-----|
| <b>MLH+KYTKENTÄKAAPELI</b><br>OMA0618 | Pressure transmitter for water, 0-10bar, 0-10V, Thread G1/4 | A1 | 164 |
|---------------------------------------|---|----|-----|

## 5-CDPT 5-CHANNEL DIFFERENTIAL PRESSURE TRANSMITTER

The 5-CDPT is a differential pressure transmitter with 5 measurement channel and communicates via the Modbus RTU bus.



|                          |   |    |     |
|--------------------------|---|----|-----|
| <b>5-CDPT</b><br>OMA0635 | 5-channel differential pressure transmitter | A1 | 594 |
|--------------------------|---|----|-----|

## OTHER TRANSMITTERS

Transmitters input voltage 24 AC/DC, measuring message 0-10 VDC.

|                             |   |    |     |
|-----------------------------|---|----|-----|
| <b>HDH</b><br>OMB0055       | CO2 and temperature sensor in room                                | A2 | 485 |
| <b>HDH-N</b><br>OMB0060     | CO2 and temperature sensor in room with display                   | A2 | 573 |
| <b>HDK</b><br>OMB0061       | CO2 and temperature sensor in duct                                | A2 | 650 |
| <b>HDK-N</b><br>OMB0062     | CO2 and temperature sensor in duct with display                   | A2 | 739 |
| <b>IVL 10</b><br>OMB0082    | Air flow transmitter 0-10 m/s                                     | A2 | 196 |
| <b>KLH 100</b><br>OMB0113   | Room moisture and temperature transmitter                         | A2 | 204 |
| <b>KLH 100-N</b><br>OMB0114 | Room moisture and temperature transmitter with display            | A2 | 274 |
| <b>VPL 16</b><br>OMB0428    | Pressure transmitter for water network, below 16 bar              | A2 | 294 |
| <b>VPL 16-N</b><br>OMB0429  | Pressure transmitter for water network with display, below 16 bar | A2 | 352 |
| <b>LUX 34</b><br>OMB0132    | Lux sensor for outdoor use  | A2 | 294 |
| <b>TUNA 20</b><br>OMB0411   | Wind speed (0...20 m/s) and temperature transmitter               | A2 | 372 |
| <b>KLK 100</b><br>OMB0115   | Duct moisture and temperature transmitter                         | A2 | 294 |
| <b>KLK 100-N</b><br>OMB0116 | Duct moisture and temperature transmitter with display            | A2 | 352 |

**!** no stock product

# 2-way valves for district heating

Price EUR  
Vat 0%

## VD 2-WAY VALVES FOR DISTRICT HEATING

These valves are designed especially for flow control in hydraulic systems with high temperatures and pressures, such as district heating systems. Can be used in combination with actuators M31C150 (heating) and M41A15 (domestic hot water)

**Note.** Connections set must be ordered separately. Is not included in the price.



CONNECTION SETS:

\*)

|                              |       |         |   |                               |    |     |
|------------------------------|-------|---------|---|-------------------------------|----|-----|
| <b>VD215-0.25</b><br>OMA0386 | DN 15 | Kv 0.25 | External thread R 3/4", flush surface with seal   | L15UK-1/2" or L15HI           | A3 | 204 |
| <b>VD215-0.4</b><br>OMA0387  | DN 15 | Kv 0.4  | External thread R 3/4", flush surface with seal   | L15UK-1/2" or L15HI           | A3 | 204 |
| <b>VD215-0.63</b><br>OMA0388 | DN 15 | Kv 0.63 | External thread R 3/4", flush surface with seal   | L15UK-1/2" or L15HI           | A3 | 204 |
| <b>VD215-1.0</b><br>OMA0389  | DN 15 | Kv 1.0  | External thread R 3/4", flush surface with seal   | L15UK-1/2" or L15HI           | A3 | 204 |
| <b>VD215-1.6</b><br>OMA0390  | DN 15 | Kv 1.6  | External thread R 3/4", flush surface with seal   | L15UK-1/2" or L15HI           | A3 | 204 |
| <b>VD220-2.5</b><br>OMA0391  | DN 20 | Kv 2.5  | External thread R 1", flush surface with seal     | L20UK-3/4", L20SK-1/2", L20HI | A3 | 285 |
| <b>VD220-4.0</b><br>OMA0392  | DN 20 | Kv 4.0  | External thread R 1", flush surface with seal     | L20UK-3/4", L20SK-1/2", L20HI | A3 | 285 |
| <b>VD225-6.3</b><br>OMA0393  | DN 25 | Kv 6.3  | External thread R 1 1/4", flush surface with seal | L25UK-1", L25SK, L25HI        | A3 | 375 |
| <b>VD232-10</b><br>OMA0394   | DN 32 | Kv 10   | External thread R 1 1/2", flush surface with seal | L25SK-1" or L32HI             | A3 | 508 |

## V5016A... 2-WAY VALVES FOR DISTRICT HEATING

Cast iron, T max 150 °C, stroke length 20 mm, PN 16,

Pressure balanced district heating valve.

Can be used in combination with actuators: ML6420..., ML6425..., ML7420..., ML7425...



\*)

|                             |        |         |                         |    |      |
|-----------------------------|--------|---------|-------------------------|----|------|
| <b>V5016A1010</b><br>HON258 | DN 15  | Kv 0,4  | Flanged (length 130 mm) | A3 | 816  |
| <b>V5016A1028</b><br>HON259 | DN 15  | Kv 0,63 | Flanged (length 130 mm) | A3 | 686  |
| <b>V5016A1036</b><br>HON260 | DN 15  | Kv 1,0  | Flanged (length 130 mm) | A3 | 840  |
| <b>V5016A1044</b><br>HON261 | DN 15  | Kv 1,6  | Flanged (length 130 mm) | A3 | 840  |
| <b>V5016A1051</b><br>HON262 | DN 15  | Kv 2,5  | Flanged (length 130 mm) | A3 | 763  |
| <b>V5016A1069</b><br>HON263 | DN 15  | Kv 4,0  | Flanged (length 130 mm) | A3 | 763  |
| <b>V5016A1077</b><br>HON264 | DN 20  | Kv 6,3  | Flanged (length 150 mm) | A3 | 803  |
| <b>V5016A1085</b><br>HON265 | DN 25  | Kv 10   | Flanged (length 160 mm) | A3 | 998  |
| <b>V5016A1093</b><br>HON266 | DN 32  | Kv 16   | Flanged (length 180 mm) | A3 | 1158 |
| <b>V5016A1101</b><br>HON267 | DN 40  | Kv 25   | Flanged (length 200 mm) | A3 | 1353 |
| <b>V5016A1119</b><br>HON268 | DN 50  | Kv 40   | Flanged (length 230 mm) | A3 | 1713 |
| <b>V5016A1127</b><br>HON269 | DN 65  | Kv 63   | Flanged (length 290 mm) | A3 | 2265 |
| <b>V5016A1135</b><br>HON270 | DN 80  | Kv 100  | Flanged (length 310 mm) | A3 | 2734 |
| <b>V5016A1143</b><br>HON076 | DN 100 | Kv 160  | Flanged (length 350 mm) | A3 | 4225 |
| <b>V5016A1150</b><br>HON077 | DN 125 | Kv 250  | Flanged (length 400 mm) | A3 | 6252 |
| <b>V5016A1168</b><br>HON078 | DN 150 | Kv 360  | Flanged (length 480 mm) | A3 | 6820 |

! no stock product

\*) We reserve the right to change the prices according to Honeywell.

# 2-way valves for district heating

Price EUR  
Vat 0%

## V5025A... 2-WAY VALVES FOR DISTRICT HEATING

Cast iron, Pressure balanced district heating valve., PN25, T max 200 °C

Suitable actuators: ML6420..., ML6421..., ML6425..., ML7420..., ML7421..., ML7425



\*)

|   |                             |        |         |                    |              |    |      |
|---|-----------------------------|--------|---------|--------------------|--------------|----|------|
| ! | <b>V5025A1027</b><br>HON080 | DN 15  | Kv 0.63 | Flanged (L=130 mm) | Stroke 20 mm | A3 | 1174 |
| ! | <b>V5025A1035</b><br>HON081 | DN 15  | Kv 1.0  | Flanged (L=130 mm) | Stroke 20 mm | A3 | 1174 |
| ! | <b>V5025A1050</b><br>HON083 | DN 15  | Kv 2.5  | Flanged (L=130 mm) | Stroke 20 mm | A3 | 1174 |
| ! | <b>V5025A1068</b><br>HON084 | DN 15  | Kv 4.0  | Flanged (L=130 mm) | Stroke 20 mm | A3 | 1174 |
| ! | <b>V5025A1076</b><br>HON085 | DN 20  | Kv 6.3  | Flanged (L=150 mm) | Stroke 20 mm | A3 | 1193 |
| ! | <b>V5025A1084</b><br>HON086 | DN 25  | Kv 10   | Flanged (L=160 mm) | Stroke 20 mm | A3 | 1212 |
| ! | <b>V5025A1092</b><br>HON087 | DN 32  | Kv 16   | Flanged (L=180 mm) | Stroke 20 mm | A3 | 1326 |
| ! | <b>V5025A1100</b><br>HON089 | DN 40  | Kv 25   | Flanged (L=200 mm) | Stroke 20 mm | A3 | 1667 |
| ! | <b>V5025A1118</b><br>HON090 | DN 50  | Kv 40   | Flanged (L=230 mm) | Stroke 20 mm | A3 | 1932 |
| ! | <b>V5025A1126</b><br>HON091 | DN 65  | Kv 63   | Flanged (L=290 mm) | Stroke 20 mm | A3 | 2141 |
| ! | <b>V5025A1134</b><br>HON092 | DN 80  | Kv 100  | Flanged (L=310 mm) | Stroke 20 mm | A3 | 3126 |
| ! | <b>V5025A1142</b><br>HON093 | DN 100 | Kv 160  | Flanged (L=350 mm) | Stroke 38 mm | A3 | 4642 |
| ! | <b>V5025A1159</b><br>HON094 | DN 125 | Kv 250  | Flanged (L=400 mm) | Stroke 38 mm | A3 | 8184 |

## V5049A... 2-WAY VALVES FOR DISTRICT HEATING

Cast iron, Pressure balanced district heating valve., PN40, T max 220 °C

Suitable actuators: ML6420..., ML6421..., ML6425..., ML7420..., ML7421..., ML7425



\*)

|   |                             |       |         |                    |              |    |      |
|---|-----------------------------|-------|---------|--------------------|--------------|----|------|
| ! | <b>V5049A2043</b><br>HON110 | DN 15 | Kv 0.63 | Flanged (L=130 mm) | Stroke 20 mm | A3 | 2842 |
| ! | <b>V5049A1433</b><br>HON097 | DN 15 | Kv 1.6  | Flanged (L=130 mm) | Stroke 20 mm | A3 | 2368 |
| ! | <b>V5049A1441</b><br>HON098 | DN 15 | Kv 2.5  | Flanged (L=130 mm) | Stroke 20 mm | A3 | 2368 |
| ! | <b>V5049A1458</b><br>HON099 | DN 15 | Kv 4.0  | Flanged (L=130 mm) | Stroke 20 mm | A3 | 2368 |
| ! | <b>V5049A1508</b><br>HON100 | DN 20 | Kv 6.3  | Flanged (L=150 mm) | Stroke 20 mm | A3 | 2463 |
| ! | <b>V5049A1565</b><br>HON101 | DN 25 | Kv 10   | Flanged (L=160 mm) | Stroke 20 mm | A3 | 2469 |
| ! | <b>V5049A1573</b><br>HON102 | DN 32 | Kv 16   | Flanged (L=180 mm) | Stroke 20 mm | A3 | 2804 |
| ! | <b>V5049A1581</b><br>HON103 | DN 40 | Kv 25   | Flanged (L=200 mm) | Stroke 20 mm | A3 | 2993 |
| ! | <b>V5049A1599</b><br>HON104 | DN 50 | Kv 40   | Flanged (L=230 mm) | Stroke 20 mm | A3 | 5001 |
| ! | <b>V5049A1607</b><br>HON105 | DN 65 | Kv 63   | Flanged (L=290 mm) | Stroke 20 mm | A3 | 6252 |

! no stock product



# 2-way valves for heating and ventilation

Price EUR  
Vat 0%

## VSMF-2... 2-WAY VALVE

Red metal, T max 120 °C, stroke 6,5 mm, PN16

Applications: Heating and ventilation

Suitable for motors: M31C150 ja M41A15

**Note.** Connections sets must be ordered separately. Do not include in the price.



CONNECTION SETS:

\*)

|                                |       |         |                          |                             |                   |    |     |
|--------------------------------|-------|---------|--------------------------|-----------------------------|-------------------|----|-----|
| <b>VSMF-215-0.25</b><br>HON295 | DN 15 | Kv 0.25 | External thread R 1/2"   | L15UK3/8"                   |                   | A3 | 57  |
| <b>VSMF-215-0.4</b><br>HON296  | DN 15 | Kv 0.4  | External thread R 1/2"   | L15UK3/8"                   |                   | A3 | 57  |
| <b>VSMF-215-0.63</b><br>HON297 | DN 15 | Kv 0.63 | External thread R 1/2"   | L15UK3/8"                   |                   | A3 | 57  |
| <b>VSMF-215-1.0</b><br>HON298  | DN 15 | Kv 1.0  | External thread R 1/2"   | L15UK3/8"                   |                   | A3 | 57  |
| <b>VSMF-215-1.6</b><br>HON299  | DN 15 | Kv 1.6  | External thread R 1/2"   | L15UK3/8"                   |                   | A3 | 57  |
| <b>VSMF-215-2.5</b><br>HON222  | DN 15 | Kv 2.5  | External thread R 1/2"   | L15UK3/8"                   |                   | A3 | 57  |
| <b>VSMF-220-2.5</b><br>HON300  | DN 20 | Kv 2.5  | External thread R 3/4"   | L15UK-1/2", L15HI           |                   | A3 | 89  |
| <b>VSMF-220-4.0</b><br>HON301  | DN 20 | Kv 4.0  | External thread R 3/4"   | L15UK-1/2", L15HI           |                   | A3 | 89  |
| <b>VSMF-225-6.3P</b><br>HON302 | DN 25 | Kv 6.3  | External thread R 1 1/4" | L25UK-1", L25SK-3/4", L25HI | Pressure balanced | A3 | 227 |
| <b>VSMF-225-8.0P</b><br>HON303 | DN 25 | Kv 8.0  | External thread R 1 1/4" | L25UK-1", L25SK-3/4", L25HI | Pressure balanced | A3 | 227 |

## V5822A... 2-WAY VALVE

Brass, PN16, T max 120 °C, actuators HW 6.5 or 2.5 mm stroke



CONNECTION SETS:

\*)

|                             |       |         |   |             |    |     |
|-----------------------------|-------|---------|---|-------------|----|-----|
| <b>V5822A1006</b><br>HON130 | DN 15 | Kv 0.16 | external thread R1/2", stroke 6,5 mm                  | ACN-15C/S/T | A3 | 123 |
| <b>V5822A1014</b><br>HON131 | DN 15 | Kv 0.25 | external thread R1/2", stroke 6,5 mm                  | ACN-15C/S/T | A3 | 123 |
| <b>V5822A1022</b><br>HON132 | DN 15 | Kv 0.40 | external thread R1/2", stroke 6,5 mm                  | ACN-15C/S/T | A3 | 123 |
| <b>V5822A1030</b><br>HON133 | DN 15 | Kv 0.63 | external thread R1/2", stroke 6,5 mm                  | ACN-15C/S/T | A3 | 115 |
| <b>V5822A1048</b><br>HON134 | DN 15 | Kv 1.0  | external thread R1/2", stroke 6,5 mm                  | ACN-15C/S/T | A3 | 115 |
| <b>V5822A1055</b><br>HON135 | DN 15 | Kv 1.6  | external thread R1/2", stroke 6,5 mm                  | ACN-15C/S/T | A3 | 115 |
| <b>V5822A1063</b><br>HON136 | DN 20 | Kv 2.5  | external thread R3/4", stroke 6,5 mm                  | ACN-20C/S/T | A3 | 145 |
| <b>V5822A1071</b><br>HON137 | DN 20 | Kv 4.0  | external thread R3/4", stroke 6,5 mm                  | ACN-20C/S/T | A3 | 145 |
| <b>V5822A4000</b><br>HON138 | DN 15 | Kv 1.6  | external thread R1/2", stroke 2,5 mm, On/Off -control | ACN-15C/S/T | A3 | 93  |
| <b>V5822A4018</b><br>HON139 | DN 20 | Kv 2.5  | external thread R3/4", stroke 2,5 mm, On/Off -control | ACN-20C/S/T | A3 | 115 |

! no stock product

\*) We reserve the right to change the prices according to Honeywell.

# 2-way valves for heating and ventilation

Price EUR  
Vat 0%

## V5832A... 2-WAY VALVE

Brass, PN16, T max 120 °C, stroke 6,5 mm



\*)

CONNECTION SETS:

|                        |       |         |  |                   |    |     |
|------------------------|-------|---------|--|-------------------|----|-----|
| ! V5832A1004<br>HON162 | DN 15 | Kv 0.16 | external thread R1/2"                  | L15UK-3/8"        | A3 | 88  |
| ! V5832A1012<br>HON163 | DN 15 | Kv 0.25 | external thread R1/2"                  | L15UK-3/8"        | A3 | 88  |
| ! V5832A1020<br>HON164 | DN 15 | Kv 0.40 | external thread R1/2"                  | L15UK-3/8"        | A3 | 88  |
| ! V5832A1038<br>HON165 | DN 15 | Kv 0.63 | external thread R1/2"                  | L15UK-3/8"        | A3 | 88  |
| ! V5832A1046<br>HON166 | DN 15 | Kv 1.0  | external thread R1/2"                  | L15UK-3/8"        | A3 | 88  |
| ! V5832A1053<br>HON167 | DN 15 | Kv 1.6  | external thread R1/2"                  | L15UK-3/8"        | A3 | 88  |
| ! V5832A1061<br>HON168 | DN 20 | Kv 2.5  | external thread R3/4"                  | L15UK-1/2", L15HI | A3 | 121 |
| ! V5832A1079<br>HON169 | DN 20 | Kv 4.0  | external thread R3/4"                  | L15UK-1/2", L15HI | A3 | 121 |
| ! V5832A4008<br>HON170 | DN 15 | Kv 1.6  | external thread R1/2" On/Off -control  | L15UK-3/8"        | A3 | 74  |
| ! V5832A4016<br>HON171 | DN 20 | Kv 2.5  | external thread R3/4", On/Off -control | L15UK-1/2", L15HI | A3 | 99  |

## V5328A... 2-WAY VALVE, FLANGED

Cast iron, PN16

For heating and ventilation



\*)

|                        |        |         |                   |              |            |    |      |
|------------------------|--------|---------|-------------------|--------------|------------|----|------|
| ! V5328A1146<br>HON124 | DN 15  | Kv 0,4  | Flanged (L=130mm) | Stroke 20 mm | Tmax 170°C | A3 | 784  |
| ! V5328A1153<br>HON125 | DN 15  | Kv 0,63 | Flanged (L=130mm) | Stroke 20 mm | Tmax 170°C | A3 | 784  |
| ! V5328A1005<br>HON114 | DN 15  | Kv 1,0  | Flanged (L=130mm) | Stroke 20 mm | Tmax 170°C | A3 | 713  |
| ! V5328A1013<br>HON115 | DN 15  | Kv 1,6  | Flanged (L=130mm) | Stroke 20 mm | Tmax 170°C | A3 | 784  |
| ! V5328A1021<br>HON116 | DN 15  | Kv 2,5  | Flanged (L=130mm) | Stroke 20 mm | Tmax 170°C | A3 | 713  |
| ! V5328A1039<br>HON117 | DN 15  | Kv 4,0  | Flanged (L=130mm) | Stroke 20 mm | Tmax 170°C | A3 | 713  |
| ! V5328A1047<br>HON118 | DN 20  | Kv 4,0  | Flanged (L=150mm) | Stroke 20 mm | Tmax 170°C | A3 | 806  |
| ! V5328A1054<br>HON119 | DN 20  | Kv 6,3  | Flanged (L=150mm) | Stroke 20 mm | Tmax 170°C | A3 | 682  |
| ! V5328A1062<br>HON120 | DN 25  | Kv 10   | Flanged (L=160mm) | Stroke 20 mm | Tmax 170°C | A3 | 709  |
| ! V5328A1070<br>HON121 | DN 32  | Kv 16   | Flanged (L=180mm) | Stroke 20 mm | Tmax 170°C | A3 | 872  |
| ! V5328A1088<br>HON122 | DN 40  | Kv 25   | Flanged (L=200mm) | Stroke 20 mm | Tmax 170°C | A3 | 1091 |
| ! V5328A1096<br>HON271 | DN 50  | Kv 40   | Flanged (L=230mm) | Stroke 20 mm | Tmax 170°C | A3 | 1273 |
| ! V5328A1104<br>HON272 | DN 65  | Kv 63   | Flanged (L=290mm) | Stroke 20 mm | Tmax 170°C | A3 | 1582 |
| ! V5328A1112<br>HON273 | DN 80  | Kv 100  | Flanged (L=310mm) | Stroke 20 mm | Tmax 170°C | A3 | 2000 |
| ! V5328A1195<br>HON126 | DN 100 | Kv 160  | Flanged (L=350mm) | Stroke 38 mm | Tmax 200°C | A3 | 2818 |
| ! V5328A1203<br>HON127 | DN 125 | Kv 250  | Flanged (L=400mm) | Stroke 38 mm | Tmax 200°C | A3 | 5176 |
| ! V5328A1211<br>HON128 | DN 150 | Kv 360  | Flanged (L=480mm) | Stroke 38 mm | Tmax 200°C | A3 | 5703 |

## VBG2... 2-WAY CONTROL BALL VALVE

Brass, PN25, T max 120 °C, Angle of rotation 90°, Suitable actuators MNV...

Valve serie available on request. See datasheet from our website.



# 2-way valves for heating and ventilation

Price EUR  
Vat 0%

## V5832B... 2-WAY VALVE

For the control of hot or chilled water for fan coil units, small reheaters/recoolers in electric/electronic temperature control systems. Can be used in combination with actuators M31C150 and M41A15.

**Note.** Connections sets must be ordered separately. Do not include in the price.



CONNECTION SETS:

|                             |       |        |  |              |    |     |
|-----------------------------|-------|--------|--|--------------|----|-----|
| <b>V5832B2075</b><br>HON286 | DN 25 | Kv 4.0 | External thread R 1½", flush surface with seal | L25SK-1"     | A3 | 378 |
| <b>V5832B2083</b><br>HON287 | DN 25 | Kv 6.3 | External thread R 1½", flush surface with seal | L25SK-1"     | A3 | 382 |
| <b>V5832B2091</b><br>HON288 | DN 25 | Kv 10  | External thread R 1½", flush surface with seal | L25SK-1"     | A3 | 315 |
| <b>V5832B2109</b><br>HON289 | DN 32 | Kv 16  | External thread R 2", flush surface with seal  | L32SK-1 1/4" | A3 | 349 |
| <b>V5832B2117</b><br>HON290 | DN 40 | Kv 25  | External thread R 2¼", flush surface with seal | L40SK-1 1/2" | A3 | 498 |

\*)

## V5011R 2-WAY VALVE

For heating, ventilation and domestic hot water. Can be used in combination with actuators ML6420... , ML6425..., ML7420... and ML7425...



\*)

|                             |       |         |                           |    |     |
|-----------------------------|-------|---------|---------------------------|----|-----|
| <b>V5011R1000</b><br>HON241 | DN 15 | Kv 0.63 | Internal thread, R 1/2"   | A3 | 370 |
| <b>V5011R1018</b><br>HON242 | DN 15 | Kv 1.0  | Internal thread, R 1/2"   | A3 | 370 |
| <b>V5011R1026</b><br>HON243 | DN 15 | Kv 1,6  | Internal thread, R 1/2"   | A3 | 305 |
| <b>V5011R1034</b><br>HON244 | DN 15 | Kv 2,5  | Internal thread, R 1/2"   | A3 | 305 |
| <b>V5011R1042</b><br>HON245 | DN 15 | Kv 4    | Internal thread, R 1/2"   | A3 | 376 |
| <b>V5011R1059</b><br>HON246 | DN 20 | Kv 6,3  | Internal thread, R 3/4"   | A3 | 369 |
| <b>V5011R1067</b><br>HON247 | DN 25 | Kv 10   | Internal thread, R 1"     | A3 | 436 |
| <b>V5011R1075</b><br>HON248 | DN 32 | Kv 16   | Internal thread, R 1 1/4" | A3 | 484 |
| <b>V5011R1083</b><br>HON249 | DN 40 | Kv 25   | Internal thread, R 1 1/2" | A3 | 570 |
| <b>V5011R1091</b><br>HON250 | DN 50 | Kv 40   | Internal thread, R 2"     | A3 | 686 |

## R20... 2-WAY BALL VALVES

For ventilation, heating systems and for the control of hot or chilled water for fan coil units. Can be used in combination with actuators HRYD24-SR, HRYD24-3 and HRC24-3.



\*)

|                                |       |        |  |    |     |
|--------------------------------|-------|--------|--|----|-----|
| <b>R2015-1-S1</b><br>OMB0325   | DN 15 | Kv 1,0 | Internal thread 1/2", replace the valve R210 | A2 | 90  |
| <b>R2015-1P6-S1</b><br>OMB0324 | DN 15 | Kv 1,6 | Internal thread 1/2", replace the valve R211 | A2 | 90  |
| <b>R2015-2P5-S1</b><br>OMB0326 | DN 15 | Kv 2,5 | Internal thread 1/2", replace the valve R212 | A2 | 90  |
| <b>R2020-4-S2</b><br>OMB0328   | DN 20 | Kv 4,0 | Internal thread 3/4", replace the valve R217 | A2 | 103 |
| <b>R2020-6P3-S2</b><br>OMB0329 | DN 20 | Kv 6,3 | Internal thread 3/4", replace the valve R218 | A2 | 103 |
| <b>R2020-8P6-S2</b><br>OMB0330 | DN 20 | Kv 8,6 | Internal thread 3/4", replace the valve R219 | A2 | 103 |
| <b>R2025-10-S2</b><br>OMB0331  | DN 25 | Kv 10  | Internal thread 1", replace the valve R223   | A2 | 126 |
| <b>R2025-16-S2</b><br>OMB0332  | DN 25 | Kv 16  | Internal thread 1", replace the valve R224   | A2 | 126 |

! no stock product

# 3-way valves

Price EUR  
Vat 0%

## VSMF-3... 3-WAY VALVE

Red metal, T max 120 °C, stroke length 6,5 mm PN 16

Applications: For heating and ventilation

Suitable for actuators: M31C150, M31A150 and M41A15

**Note.** Connections sets must be ordered separately. Do not include in the price.



CONNECTION SETS:

\*)

|                                  |       |         |   |                             |    |     |
|----------------------------------|-------|---------|---|-----------------------------|----|-----|
| ! <b>VSMF-315-0.25</b><br>HON223 | DN 15 | Kv 0.25 | External thread R 1/2", flush surface with seal   | L15UK-3/8"                  | A3 | 77  |
| <b>VSMF-315-0.4</b><br>HON304    | DN 15 | Kv 0,4  | External thread R 1/2", flush surface with seal   | L15UK-3/8"                  | A3 | 102 |
| <b>VSMF-315-0.63</b><br>HON305   | DN 15 | Kv 0,63 | External thread R 1/2", flush surface with seal   | L15UK-3/8"                  | A3 | 102 |
| <b>VSMF-315-1.0</b><br>HON306    | DN 15 | Kv 1,0  | External thread R 1/2", flush surface with seal   | L15UK-3/8"                  | A3 | 102 |
| <b>VSMF-315-1.6</b><br>HON307    | DN 15 | Kv 1,6  | External thread R 1/2", flush surface with seal   | L15UK-3/8"                  | A3 | 102 |
| ! <b>VSMF-315-2.5</b><br>HON224  | DN 15 | Kv 2.5  | External thread R 1/2", flush surface with seal   | L15UK-3/8"                  | A3 | 84  |
| <b>VSMF-320-2.5</b><br>HON308    | DN 20 | Kv 2.5  | External thread R 3/4", flush surface with seal   | L15UK-1/2", L15HI           | A3 | 93  |
| <b>VSMF-320-4.0</b><br>HON309    | DN 20 | Kv 4    | External thread R 3/4", flush surface with seal   | L15UK-1/2", L15HI           | A3 | 93  |
| <b>VSMF-325-6.3P</b><br>HON310   | DN 25 | Kv 6.3  | External thread R 1 1/4", flush surface with seal | L25UK-1", L25SK-3/4", L25HI | A3 | 250 |
| <b>VSMF-325-8.0P</b><br>HON311   | DN 25 | Kv 8.0  | External thread R 1 1/4", flush surface with seal | L25UK-1", L25SK-3/4", L25HI | A3 | 250 |

## V5833A... 3-WAY VALVE

Red metal, PN16

Applications: For heating, ventilation and domestic hot water

Suitable for motors: M31C150 and M41A15

**Note.** Connections sets must be ordered separately. Do not include in the price.



CONNECTION SETS:

\*)

|                               |       |                        |   |                            |    |     |
|-------------------------------|-------|------------------------|---|----------------------------|----|-----|
| ! <b>V5833A1003</b><br>HON172 | DN 15 | Kv A-AB 0.25 B-AB 0.16 | External thread R1/2", Tmax 120°C, stroke 6,5 mm                      | L15UK-3/8"                 | A3 | 118 |
| ! <b>V5833A1011</b><br>HON173 | DN 15 | Kv A-AB 0.4 B-AB 0.25  | External thread R1/2", Tmax 120°C, stroke 6,5 mm                      | L15UK-3/8"                 | A3 | 118 |
| ! <b>V5833A1029</b><br>HON174 | DN 15 | Kv A-AB 0.63 B-AB 0.4  | External thread R1/2", Tmax 120°C, stroke 6,5 mm                      | L15UK-3/8"                 | A3 | 118 |
| ! <b>V5833A1037</b><br>HON175 | DN 15 | Kv A-AB 1.0 B-AB 0.63  | External thread R1/2", Tmax 120°C, stroke 6,5 mm                      | L15UK-3/8"                 | A3 | 118 |
| ! <b>V5833A1045</b><br>HON176 | DN 15 | Kv A-AB 1.6 B-AB 1.0   | External thread R1/2", Tmax 120°C, stroke 6,5 mm                      | L15UK-3/8"                 | A3 | 118 |
| ! <b>V5833A4007</b><br>HON180 | DN 15 | Kv A-AB 1.6 B-AB 1.6   | External thread R1/2", Tmax 120°C, stroke 2,5 mm, On/Off -control     | L15UK-3/8"                 | A3 | 113 |
| ! <b>V5833A3009</b><br>HON178 | DN 20 | Kv A-AB 2.5 B-AB 2.5   | External thread R3/4", Tmax 120°C, stroke 6,5 mm                      | L15UK-1/2", L15HI          | A3 | 185 |
| ! <b>V5833A4015</b><br>HON181 | DN 20 | Kv A-AB 2.5 B-AB 2.5   | External thread R3/4", Tmax 120°C, stroke 2,5 mm, On/Off -control     | L15UK-1/2", L15HI          | A3 | 113 |
| ! <b>V5833A3017</b><br>HON179 | DN 20 | Kv A-AB 4.0 B-AB 4.0   | External thread R3/4", Tmax 120°C, stroke 6,5 mm                      | L15UK-1/2", L15HI          | A3 | 187 |
| ! <b>V5833A2076</b><br>HON177 | DN 25 | Kv 4.0                 | External thread R1 1/2", Tmax 130°C, stroke 6,5 mm, Pressure balanced | L25SK-1", L32HI            | A3 | 300 |
| <b>V5833A2084</b><br>HON291   | DN 25 | Kv 6.3                 | External thread R1 1/2", Tmax 130°C, stroke 6,5 mm, Pressure balanced | 25SK-1", L32HI             | A3 | 322 |
| <b>V5833A2092</b><br>HON292   | DN 25 | Kv 10                  | External thread R1 1/2", Tmax 130°C, stroke 6,5 mm, Pressure balanced | 25SK-1", L32HI             | A3 | 322 |
| <b>V5833A2100</b><br>HON293   | DN 32 | Kv 16                  | External thread R2", Tmax 130°C, stroke 6,5 mm, Pressure balanced     | L32SK-1 1/4"               | A3 | 342 |
| <b>V5833A2118</b><br>HON294   | DN 40 | Kv 25                  | External thread R2 1/4", Tmax 130°C, stroke 6,5 mm, Pressure balanced | L40UK-1 1/2", L40SK-1 1/2" | A3 | 456 |

! no stock product

\*) We reserve the right to change the prices according to Honeywell.

# 3-way valves

Price EUR  
Vat 0%

## V5013R... 3-WAY VALVE

Red metal, T max 170 °C, stroke length 20 mm, PN 16

Applications: For heating, domestic hot water and ventilation

Suitable for actuators: ML6420... , ML6425..., ML7420... and ML7425...



\*)

|                             |       |        |                           |    |     |
|-----------------------------|-------|--------|---------------------------|----|-----|
| <b>V5013R1032</b><br>HON251 | DN 15 | Kv 2.5 | Internal thread, R 1/2"   | A3 | 286 |
| <b>V5013R1040</b><br>HON252 | DN 15 | Kv 4   | Internal thread, R 1/2"   | A3 | 286 |
| <b>V5013R1057</b><br>HON253 | DN 20 | Kv 6.3 | Internal thread, R 3/4"   | A3 | 315 |
| <b>V5013R1065</b><br>HON254 | DN 25 | Kv 10  | Internal thread, R 1"     | A3 | 316 |
| <b>V5013R1073</b><br>HON255 | DN 32 | Kv 16  | Internal thread, R 1 1/4" | A3 | 379 |
| <b>V5013R1081</b><br>HON256 | DN 40 | Kv 25  | Internal thread, R 1 1/2" | A3 | 462 |
| <b>V5013R1099</b><br>HON257 | DN 50 | Kv 40  | Internal thread, R 2"     | A3 | 582 |

## V5013E... 3-WAY VALVE

Red metal, PN16, T max 170 °C, stroke length 20 mm

**Note.** Connections sets must be ordered separately. Do not include in the price.

Suitable for actuators: ML6420..., ML6425..., ML7420..., ML7425...

CONNECTION SETS:

\*)

|                             |       |        |                           |                               |    |     |
|-----------------------------|-------|--------|---------------------------|-------------------------------|----|-----|
| <b>V5013E1063</b><br>HON069 | DN 15 | Kv 2.5 | External thread, R 1/2"   | L15UK-3/8"                    | A3 | 397 |
| <b>V5013E1071</b><br>HON070 | DN 15 | Kv 4   | External thread, R 1/2"   | L15UK-3/8"                    | A3 | 397 |
| <b>V5013E1089</b><br>HON071 | DN 20 | Kv 6.3 | External thread, R 3/4"   | L15UK-1/2", L15HI             | A3 | 421 |
| <b>V5013E1097</b><br>HON072 | DN 25 | Kv 10  | External thread, R 1"     | L20UK-3/4", L20SK-1/2", L20HI | A3 | 440 |
| <b>V5013E1105</b><br>HON073 | DN 32 | Kv 16  | External thread, R 1 1/4" | L25UK-1", L25SK-3/4", L25HI   | A3 | 523 |
| <b>V5013E1113</b><br>HON074 | DN 40 | Kv 25  | External thread, R 1 1/2" | L25SK-1", L32HI               | A3 | 604 |
| <b>V5013E1121</b><br>HON075 | DN 50 | Kv 40  | External thread, R 2"     | L32SK-1 1/4"                  | A3 | 780 |

## V5329... 3-WAY VALVE

Cast iron, T max 170 °C, stroke length 20 mm, PN 16

Applications: For heating, domestic hot water and ventilation

Suitable for actuators: ML6420... , ML6425..., ML7420... and ML7425...



\*)

|                             |       |        |         |    |      |
|-----------------------------|-------|--------|---------|----|------|
| <b>V5329A1004</b><br>HON312 | DN 15 | Kv 2.5 | Flanged | A3 | 872  |
| <b>V5329A1012</b><br>HON129 | DN 15 | Kv 4.0 | Flanged | A3 | 872  |
| <b>V5329A1020</b><br>HON313 | DN 20 | Kv 6.3 | Flanged | A3 | 891  |
| <b>V5329A1038</b><br>HON274 | DN 25 | Kv 10  | Flanged | A3 | 909  |
| <b>V5329A1046</b><br>HON275 | DN 32 | Kv 16  | Flanged | A3 | 973  |
| <b>V5329A1053</b><br>HON276 | DN 40 | Kv 25  | Flanged | A3 | 931  |
| <b>V5329A1061</b><br>HON277 | DN 50 | Kv 40  | Flanged | A3 | 1118 |
| <b>V5329A1079</b><br>HON278 | DN 65 | Kv 63  | Flanged | A3 | 1435 |
| <b>V5329A1087</b><br>HON279 | DN 80 | Kv 100 | Flanged | A3 | 2061 |

! no stock product



# 3-way valves

Price EUR  
Vat 0%

## V5823A... 3-WAY VALVE

Brass, PN16, T max 120 °C, HW-actuators with stroke length 6.5mm or 2.5 mm  
Applications: heating and ventilation



\*)

CONNECTION SETS:

|   |                             |       |         |  |             |    |     |
|---|-----------------------------|-------|---------|--|-------------|----|-----|
| ! | <b>V5823A2003</b><br>HON140 | DN 15 | Kv 0.25 | External thread, R 1/2", stroke 6,5 mm                   | ACN-15C/S/T | A3 | 155 |
| ! | <b>V5823A2011</b><br>HON141 | DN 15 | Kv 0.40 | External thread, R 1/2", stroke 6,5 mm                   | ACN-15C/S/T | A3 | 155 |
| ! | <b>V5823A2029</b><br>HON142 | DN 15 | Kv 0.63 | External thread, R 1/2", stroke 6,5 mm                   | ACN-15C/S/T | A3 | 155 |
| ! | <b>V5823A2037</b><br>HON143 | DN 15 | Kv 1.0  | External thread, R 1/2", stroke 6,5 mm                   | ACN-15C/S/T | A3 | 136 |
| ! | <b>V5823A2045</b><br>HON144 | DN 15 | Kv 1.6  | External thread, R 1/2", stroke 6,5 mm                   | ACN-15C/S/T | A3 | 136 |
| ! | <b>V5823A2052</b><br>HON145 | DN 20 | Kv 2.5  | External thread, R 3/4", stroke 6,5 mm                   | ACN-20C/S/T | A3 | 178 |
| ! | <b>V5823A2060</b><br>HON146 | DN 20 | Kv 4.0  | External thread, R 3/4", stroke 6,5 mm                   | ACN-20C/S/T | A3 | 178 |
| ! | <b>V5823A2151</b><br>HON147 | DN 20 | Kv 2.5  | External thread, R 3/4", stroke 6,5 mm, sp 240 kPa/ -kPa | ACN-20C/S/T | A3 | 178 |
| ! | <b>V5823A2169</b><br>HON148 | DN 20 | Kv 4.0  | External thread, R 3/4", stroke 6,5 mm, sp 240 kPa/ -kPa | ACN-20C/S/T | A3 | 178 |
| ! | <b>V5823A4009</b><br>HON149 | DN 15 | Kv 1.6  | External thread, R 1/2", stroke 2,5 mm, On/Off -control  | ACN-15C/S/T | A3 | 123 |
| ! | <b>V5823A4017</b><br>HON150 | DN 20 | Kv 2.5  | External thread, R 3/4", stroke 2,5 mm, On/Off -control  | ACN-20C/S/T | A3 | 123 |

## V5823C... 3-WAY VALVE

Brass, PN16, T max 120 °C, three-way with bypass  
HW-actuators with stroke length 6.5mm or 2.5 mm  
Applications: heating and ventilation



\*)

CONNECTION SETS:

|   |                             |       |                        |  |             |    |     |
|---|-----------------------------|-------|------------------------|--|-------------|----|-----|
| ! | <b>V5823C2009</b><br>HON151 | DN 15 | Kv A-AB 0.25 B-AB 0.16 | External thread, R 1/2", stroke 6,5 mm             | ACN-15C/S/T | A3 | 177 |
| ! | <b>V5823C2017</b><br>HON152 | DN 15 | Kv A-AB 0.4 B-AB 0.25  | External thread, R 1/2", stroke 6,5 mm             | ACN-15C/S/T | A3 | 162 |
| ! | <b>V5823C2025</b><br>HON153 | DN 15 | Kv A-AB 0.63 B-AB 0.4  | External thread, R 1/2", stroke 6,5 mm             | ACN-15C/S/T | A3 | 151 |
| ! | <b>V5823C2033</b><br>HON154 | DN 15 | Kv A-AB 1.0 B-AB 0.63  | External thread, R 1/2", stroke 6,5 mm             | ACN-15C/S/T | A3 | 149 |
| ! | <b>V5823C2041</b><br>HON155 | DN 15 | Kv A-AB 1.6 B-AB 1.0   | External thread, R 1/2", stroke 6,5 mm             | ACN-15C/S/T | A3 | 147 |
| ! | <b>V5823C2058</b><br>HON156 | DN 20 | Kv A-AB 2.5 B-AB 1.6   | External thread, R 3/4", stroke 6,5 mm             | ACN-20C/S/T | A3 | 240 |
| ! | <b>V5823C2066</b><br>HON157 | DN 20 | Kv A-AB 4.0 B-AB 2.5   | External thread, R 3/4", stroke 6,5 mm             | ACN-20C/S/T | A3 | 240 |
| ! | <b>V5823C2157</b><br>HON158 | DN 20 | Kv A-AB 2.5 B-AB 1.6   | External thread, R 3/4", stroke 6,5 mm, sp 240 kPa | ACN-20C/S/T | A3 | 225 |
| ! | <b>V5823C2165</b><br>HON159 | DN 20 | Kv A-AB 4.0 B-AB 2.5   | External thread, R 3/4", stroke 6,5 mm, sp 240 kPa | ACN-20C/S/T | A3 | 240 |
| ! | <b>V5823C4005</b><br>HON160 | DN 15 | Kv 1.6                 | External thread, R 1/2", stroke 2,5 mm             | ACN-15C/S/T | A3 | 123 |
| ! | <b>V5823C4013</b><br>HON161 | DN 20 | Kv 2.5                 | External thread, R 3/4", stroke 2,5 mm             | ACN-20C/S/T | A3 | 123 |

! no stock product

# 3-way valves

Price EUR  
Vat 0%

## V5050A... 3-WAY VALVE

Cast iron, PN16, Tmax 220 °C, stroke 38 mm  
Applications: heating and ventilation  
Actuators 38 mm ML6421... or ML7421...



\*)

|   |                             |        |        |         |    |      |
|---|-----------------------------|--------|--------|---------|----|------|
| ! | <b>V5050A1090</b><br>HON111 | DN 100 | Kv 160 | Flanged | A3 | 3228 |
| ! | <b>V5050A1108</b><br>HON112 | DN 125 | Kv 250 | Flanged | A3 | 4581 |
| ! | <b>V5050A1116</b><br>HON113 | DN 150 | Kv 360 | Flanged | A3 | 6094 |

## R30... 3-WAY BALL VALVE

Nickel-plated brass, T max 100 ° C, PN 16  
Applications: For heating and ventilation  
Suitable for motors: EH-800 models + SOV BELIMO, HRC24-3, HRYD24-SR, HRYD24-3



\*)

|                                |       |         |  |    |     |
|--------------------------------|-------|---------|--|----|-----|
| <b>R3015-P63-S1</b><br>OMB0340 | DN 15 | Kv 0.63 | Internal threaded connect, thread 1/2", replace the valve R309   | A2 | 158 |
| <b>R3015-1-S1</b><br>OMB0338   | DN 15 | Kv 1.0  | Internal threaded connect, thread 1/2", replace the valve R310   | A2 | 158 |
| <b>R3015-1P6-S1</b><br>OMB0337 | DN 15 | Kv 1.6  | Internal threaded connect, thread 1/2", replace the valve R311   | A2 | 158 |
| <b>R3015-2P5-S1</b><br>OMB0339 | DN 15 | Kv 2.5  | Internal threaded connect, thread 1/2", replace the valve R312   | A2 | 158 |
| <b>R3020-4-S2</b><br>OMB0341   | DN 20 | Kv 4.0  | Internal threaded connect, thread 3/4", replace the valve R317   | A2 | 176 |
| <b>R3020-6P3-S2</b><br>OMB0342 | DN 20 | Kv 6.3  | Internal threaded connect, thread 3/4", replace the valve R318   | A2 | 176 |
| <b>R3025-10-S2</b><br>OMB0343  | DN 25 | Kv 10   | Internal threaded connect, thread 1", replace the valve R323     | A2 | 221 |
| <b>R3032-16-S3</b><br>OMB0344  | DN 32 | Kv 16   | Internal threaded connect, thread 1 1/4", replace the valve R331 | A2 | 312 |

## VBG3... 3-WAY CONTROL BALL VALVE

Brass, PN25, Tmax 120 °C, angle of rotation 90°C, Suitable actuators MVN...

Applications: heating and ventilation

Valve serie available on request. See datasheet from our website.



! no stock product

# Connection sets

Price EUR  
Vat 0%

## EXTERNAL THREADED CONNECTIONS

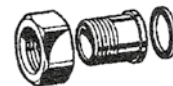

All connection sets made of zinc covering durability brass.

|                               |       |   |    |     |
|-------------------------------|-------|---|----|-----|
| <b>L15UK-3/8"</b><br>OMB0183  | DN 15 | External threaded R 3/8", Internal thread to valve R 1/2"     | A1 | 14  |
| <b>L15UK-1/2"</b><br>OMB0120  | DN 15 | External threaded R 1/2", Internal thread to valve R 3/4"     | A1 | 34  |
| <b>ACN-15T</b><br>OMB0190     | DN 15 | External threaded R 3/8", tapered                             | A1 | 18  |
| <b>L20UK-3/4"</b><br>OMB0121  | DN 20 | External threaded R 3/4", Internal thread to valve R 1"       | A1 | 38  |
| <b>L25UK-1"</b><br>OMB0122    | DN 25 | External threaded R 1", Internal thread to valve R 1 1/4"     | A1 | 23  |
| <b>L40UK-1 1/2"</b><br>OMB188 | DN 40 | External threaded R 1 1/2", Internal thread to valve R 2 1/4" | A1 | 145 |

## INTERNAL THREADED CONNECTIONS

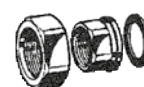

All connection sets made of zinc covering durability brass.

|                                   |       |   |    |    |
|-----------------------------------|-------|---|----|----|
| <b>L20SK-1/2"-1/2"</b><br>OMA0198 | DN 20 | Internal thread R 1/2", Internal thread to valve R 1"       | A1 | 23 |
| <b>L25SK-1"</b><br>OMB0185        | DN 25 | Internal thread R 1", Internal thread to valve R 1 1/2"     | A1 | 28 |
| <b>L25SK-3/4"</b><br>OMA0200      | DN 25 | Internal thread R 1", Internal thread to valve R 1 1/4"     | A1 | 27 |
| <b>L32SK-1 1/4"</b><br>OMB0187    | DN 32 | Internal thread R 1 1/4", Internal thread to valve R 2"     | A1 | 48 |
| <b>L40SK-1 1/2"</b><br>OMB0189    | DN 40 | Internal thread R 1 1/2", Internal thread to valve R 2 1/4" | A1 | 65 |

## WELDINGS

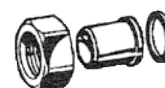

The nut made of zinc covering durability brass, the welded part made of steel.

|                         |       |   |    |    |
|-------------------------|-------|---|----|----|
| <b>L15HI</b><br>OMA0196 | DN 15 | Welding 1/2", Internal thread to valve R 3/4" | A1 | 12 |
| <b>L20HI</b><br>OMA0197 | DN 20 | Welding 3/4", Internal thread to valve R 1"   | A1 | 32 |
| <b>L25HI</b><br>OMA0199 | DN 25 | Welding 1", Internal thread to valve R 1 1/4" | A1 | 25 |

## SPARE INSERTS OF VD VALVES

|                            |                       |    |     |
|----------------------------|-----------------------|----|-----|
| <b>VDP-0.25</b><br>OMA0395 | VD-0,25 spare inserts | C2 | 177 |
| <b>VDP-0.4</b><br>OMA0396  | VD-0,4 spare inserts  | C2 | 177 |
| <b>VDP-0.63</b><br>OMA0397 | VD-0,63 spare inserts | C2 | 177 |
| <b>VDP-1.0</b><br>OMA0398  | VD-1,0 spare inserts  | C2 | 177 |
| <b>VDP-1.6</b><br>OMA0399  | VD-1,6 spare inserts  | C2 | 177 |
| <b>VDP-2.5</b><br>OMA0401  | VD-12,5 spare inserts | C2 | 177 |
| <b>VDP-4.0</b><br>OMA0402  | VD-4,0 spare inserts  | C2 | 187 |
| <b>VDP-6.3</b><br>OMA0403  | VD-6,3 spare inserts  | C2 | 218 |
| <b>VDP-10</b><br>OMA0400   | VD-10 spare inserts   | C2 | 354 |

## STEM SEALS

|                                  |   |    |     |
|----------------------------------|---|----|-----|
| <b>BOKSIT HW10MM</b><br>HON227   | Set of stem seals for V5011/13 valves               | C2 | 176 |
| <b>BOKSITIIV/SIEM</b><br>OMB0025 | Set of stem seals for Siemens 428488060: 10 mm stem | C2 | 74  |
| <b>BOKSITIIV/V</b><br>OMB0026    | Set of stem seals for V-valves OMB0026              | C2 | 65  |

# Valve adapters

Price EUR  
Vat 0%

## ADAPTER FOR VD-VALVES



**JATKE EXTENSION** The VD-valve with the adapter JATKE replaces the VS-valve of Satakunnan Valu.

|                                 |  |    |    |
|---------------------------------|--|----|----|
| <b>JATKE 215/215</b><br>OMB0083 | Pair of flange VD215 / SV 215, total length 75 mm  | A1 | 55 |
| <b>JATKE 220/215</b><br>OMB0084 | Pair of flange VD220 / SV 215, total length 75 mm  | A1 | 55 |
| <b>JATKE 220/220</b><br>OMB0085 | Pair of flange VD220 / SV 220, total length 100 mm | A1 | 69 |
| <b>JATKE 225/220</b><br>OMB0086 | Pair of flange VD225 / SV 220, total length 100 mm | A1 | 69 |
| <b>JATKE 225/225</b><br>OMB0087 | Pair of flange VD225 / SV 225, total length 115 mm | A1 | 96 |
| <b>JATKE 232/225</b><br>OMB0088 | Pair of flange VD232 / SV 225, total length 115 mm | A1 | 96 |



**JATKE VD EXTENSION** JATKE VD replaces the Osby 2SB valves or tai Siemens VVF valve

|                                  |   |    |     |
|----------------------------------|---|----|-----|
| <b>JATKE VD15-130</b><br>OMB0099 | Pair of flange for Osby 2SB and Siemens VVF valves, total length 130 mm | A1 | 92  |
| <b>JATKE VD20-130</b><br>OMB0100 | Pair of flange for Osby 2SB and Siemens VVF valves, total length 130 mm | A1 | 97  |
| <b>JATKE VD20-140</b><br>OMB0101 | Pair of flange for Osby 2SB valves, total length 140 mm                 | A1 | 97  |
| <b>JATKE VD20-160</b><br>OMB0102 | Pair of flange for Siemens VVF valves, total length 160 mm              | A1 | 97  |
| <b>JATKE VD25-140</b><br>OMB0103 | Pair of flange for Osby 2SB valves, total length 140 mm                 | A1 | 97  |
| <b>JATKE VD25-150</b><br>OMA0187 | Pair of flange for Osby 2SB valves, total length 150 mm                 | A1 | 103 |
| <b>JATKE VD25-160</b><br>OMB0104 | Pair of flange for Siemens VVF valves, total length 160 mm              | A1 | 97  |
| <b>JATKE VD32-150</b><br>OMB0105 | Pair of flange for Osby 2SB valves, total length 150 mm                 | A1 | 111 |
| <b>JATKE VD32-160</b><br>OMB0106 | Pair of flange for Siemens VVF valves, total length 160 mm              | A1 | 111 |

## JATKE RV EXTENSION

|   |                                    |    |    |
|---|------------------------------------|----|----|
| <b>JATKE PARI RV 3/4"SK-1"UK</b><br>OMA0186 | Extension 3/4" -> 1" 2 pcs + seals | A1 | 60 |
|---|------------------------------------|----|----|

## AK... ADAPTERS FOR VALVES

|                           |                                |    |     |
|---------------------------|--------------------------------|----|-----|
| <b>AK15-15</b><br>OMB0003 | Adapter set for VD15/Salina 15 | A1 | 105 |
| <b>AK20-15</b><br>OMB0004 | Adapter set for VD20/Salina 15 | A1 | 142 |
| <b>AK20-25</b><br>OMB0005 | Adapter set for VD20/Salina 25 | A1 | 192 |
| <b>AK25-25</b><br>OMB0006 | Adapter set for VD25/Salina 25 | A1 | 154 |

## FITTINGS

For actuators ML6420-, ML6425-, ML7420- ja ML7425, with stroke length of 20 mm

|                                   |  |    |    |
|-----------------------------------|--|----|----|
| <b>SOV-L&amp;G-HON</b><br>OMA0268 | Fittings for L&G VVG41-, VXG41- and VVF52 valves   | A1 | 58 |
| <b>SOV-TAC-HON</b><br>OMA0270     | Fittings for TAC V241-, V282-, V292-, V293-, V294-, V298-, V384-, V386-, V392- and V394 valves | A1 | 58 |
| <b>SW-SOV-HON</b><br>OMA0276      | Fittings between Satchwell-Honeywell   | A1 | 36 |

**Note! Combinations of all variations and sizes of valves has not been tested.**

# Valve dimensioning table

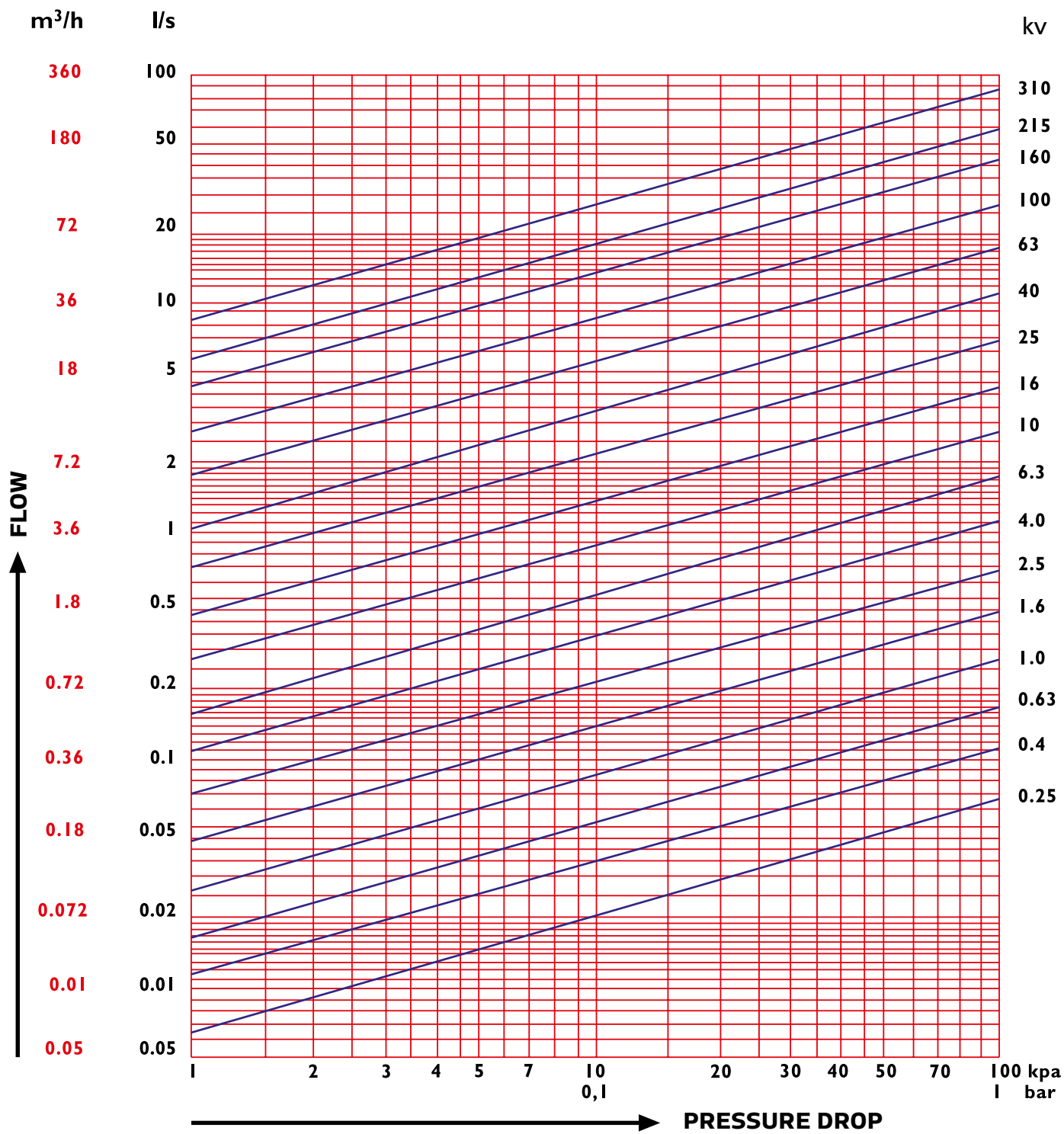



# Actuators for valves, 3-point control

Price EUR  
Vat 0%

## M31C150, M6410... VALVE ACTUATORS

Applications: For heating regulation in district heating exchangers and boiler plants, for cooling circuit regulation.

- Speed 150s/6,5mm
- Connection cable 1,5 m



\*)

|                             |   |           |     |
|-----------------------------|---|-----------|-----|
| <b>M31C150</b><br>OMA0206   | Valve actuator, 3-point control, 24 V, 50 Hz, 0,7 VA, Power 300 Nm. IP43.                   | <b>A3</b> | 177 |
| <b>M6410C2023</b><br>HON004 | Valve actuator, 3-point control, 24 V, 50 Hz, 0,7 VA, Power 180 Nm. IP43.                   | <b>A3</b> | 174 |
| <b>M6410L2023</b><br>HON008 | Valve actuator, 3-point control, 230 V, 50 Hz, 7 VA, Power 180 Nm. IP40.                    | <b>A3</b> | 250 |
| <b>M6410C4037</b><br>HON007 | Valve actuator, 3-point control, 24 V, 50 Hz, 0,7 VA, Power 300 Nm. IP43. + 2 micro switch  | <b>A3</b> | 324 |
| <b>M6410L2031</b><br>HON009 | Valve actuator, 3-point control, 230 V, 50 Hz, 7 VA, Power 300 Nm. IP40.                    | <b>A3</b> | 310 |
| <b>M6410C4029</b><br>HON006 | Valve actuator, 3-point control, 24 V, 50 Hz, 0,7 VA, Power 180 Nm. IP43. + 2 micro switch  | <b>A3</b> | 420 |
| <b>M6410L4029</b><br>HON010 | Valve actuator, 3-point control, 230 V, 50 Hz, 0,7 VA, Power 180 Nm. IP43. + 2 micro switch | <b>A3</b> | 436 |
| <b>M6410L4037</b><br>HON011 | Valve actuator, 3-point control, 230 V, 50 Hz, 0,7 VA, Power 300 Nm. IP43. + 2 micro switch | <b>A3</b> | 475 |

## ML6420A... VALVE ACTUATORS, IP54

Applications: For heating, domestic hot water and ventilation

- Suitable for valves with 20 mm stroke length.
- Power 600 Nm
- 2 pcs micro switches ready for serial control



\*)

|                              |  |           |      |
|------------------------------|--|-----------|------|
| <b>ML6420A3007</b><br>HON020 | Valve actuator, 3-point control, 24 V, 50 Hz, 4 VA, speed 60s/20mm.    | <b>A3</b> | 410  |
| <b>ML6420A3023</b><br>HON022 | Valve actuator, 3-point control, 24 V, 50 Hz, 6 VA, speed 30s/20mm.    | <b>A3</b> | 594  |
| <b>ML6420A3015</b><br>HON021 | Valve actuator, 3-point control, 230 V, 50 Hz, 6,5 VA, speed 60s/20mm. | <b>A3</b> | 836  |
| <b>ML6420A3031</b><br>HON023 | Valve actuator, 3-point control, 230 V, 50 Hz, 6,5 VA, speed 30s/20mm. | <b>A3</b> | 1039 |

## ML6421... VALVE ACTUATORS, IP54

Applications: Heating systems

- Power 1800 Nm
- 2 pcs micro switches ready for serial control



\*)

|                              |  |           |      |
|------------------------------|--|-----------|------|
| <b>ML6421A3005</b><br>HON024 | Valve actuator, 3-point control, 24 V, 50 Hz, 13 VA, speed 114s/20mm.  | <b>A3</b> | 1263 |
| <b>ML6421A3013</b><br>HON025 | Valve actuator, 3-point control, 230 V, 50 Hz, 11 VA, speed 114s/20mm. | <b>A3</b> | 1122 |
| <b>ML6421B3004</b><br>HON026 | Valve actuator, 3-point control, 24 V, 50 Hz, 13 VA, speed 210s/38mm.  | <b>A3</b> | 1486 |
| <b>ML6421B3012</b><br>HON027 | Valve actuator, 3-point control, 230 V, 50 Hz, 11 VA, speed 210s/38mm. | <b>A3</b> | 1544 |

## M6422L1003 VALVE ACTUATOR, IP54

Rotary actuator for butterfly valve

- Power 40 Nm



\*)

|                             |  |           |      |
|-----------------------------|--|-----------|------|
| <b>M6422L1003</b><br>HON012 | Valve actuator, 3-point control, 230 V, 50 Hz, 7 VA, speed 150s/90°. | <b>A3</b> | 3107 |
|-----------------------------|--|-----------|------|

! no stock product

\*) We reserve the right to change the prices according to Honeywell.

# Actuators for valves, 3-point control

Price EUR  
Vat 0%

## ML6425... VALVE ACTUATORS, IP54

Applications: For heating, domestic hot water and ventilation

- Suitable for valves with 20 mm stroke length.
- Power 600 Nm
- 2 pcs micro switches ready for serial control



\*)

|   |                              |  |           |      |
|---|------------------------------|--|-----------|------|
| ! | <b>ML6425A3006</b><br>HON028 | Valve actuator, 3-point control, 24 V, 50 Hz, 11 VA, speed 108s/20mm. 12s spring. Spring return out. | <b>A3</b> | 1265 |
| ! | <b>ML6425A3014</b><br>HON029 | Valve actuator, 3-point control, 230 V, 50 Hz, 12 VA, speed 108s/20mm. 12s jousi. Spring return out. | <b>A3</b> | 1168 |
| ! | <b>ML6425B3005</b><br>HON030 | Valve actuator, 3-point control, 24 V, 50 Hz, 11 VA, speed 108s/20mm. 12s spring. Spring return in.  | <b>A3</b> | 1826 |
| ! | <b>ML6425B3021</b><br>HON031 | Valve actuator, 3-point control, 230 V, 50 Hz, 12 VA, speed 108s/20mm. 12s spring. Spring return in. | <b>A3</b> | 1881 |

## M7410A... AND M7410C... VALVE ACTUATORS, IP43

- Suitable for valves with 2,5 mm stroke length.



\*)

|   |                             |   |           |     |
|---|-----------------------------|---|-----------|-----|
|   | <b>M7410A1001</b><br>HON013 | Valve actuator, no manual use, 3-point control, 24 V, 50 Hz, 0,7 VA, Speed 60 s/2,5 mm. Power 90 Nm. Connection cable 0,8 m. Used with control ball valve (VSOx). | <b>A3</b> | 180 |
|   | <b>M7410C1007</b><br>HON014 | Valve actuator, no manual use, 3-point control, 24 V, 50 Hz, 0,7 VA, Speed 2,5 min/6,5 mm. Power 180 Nm.  | <b>A3</b> | 248 |
| ! | <b>M7410C1015</b><br>HON015 | Valve actuator, no manual use, 3-point control, 24 V, 50 Hz, 0,7 VA, Speed 2,5 min/6,5 mm. Power 300 Nm.  | <b>A3</b> | 441 |

## MVN... VALVE ACTUATORS, IP40

- Used with control ball valve (VBGx)
- Power 3 Nm
- Speed 108s/90°.



\*)

|   |                              |   |           |     |
|---|------------------------------|---|-----------|-----|
| ! | <b>MVN613A1500</b><br>HON038 | Valve actuator, 3-point control, 24 V, 50 Hz, 1,5 VA  | <b>A3</b> | 245 |
| ! | <b>MVN663A1500</b><br>HON039 | Valve actuator, 3-point control, 230 V, 50 Hz, 4,5 VA | <b>A3</b> | 254 |

## NR-SI AND NR-HW ACTUATOR FOR RENOVATION, SIEMENS- AND HONEYWELL -VALVES

Suitable for Siemens 5,5 and Honeywell valves with 6,5 mm stroke length.

Applications: For heating, domestic hot water and ventilation



\*)

|  |                               |              |              |                       |                               |           |     |
|--|-------------------------------|--------------|--------------|-----------------------|-------------------------------|-----------|-----|
|  | <b>NRD230-3-SI</b><br>OMB0168 | Power: 500 N | Speed: 35 s  | Stroke length: 5,5 mm | Consumption: 3,5 VA 230 VAC   | <b>A2</b> | 207 |
|  | <b>NRD24-3-SI</b><br>OMB0169  | Power: 400 N | Speed: 35 s  | Stroke length: 5,5 mm | Consumption: 3 VA 24 VAC /DC  | <b>A2</b> | 207 |
|  | <b>NRD24-3-SI</b><br>OMB0165  | Power: 500 N | Speed: 140 s | Stroke length: 5,5 mm | Consumption: 3 VA 24 VAC / DC | <b>A2</b> | 185 |
|  | <b>NRD230-3-SI</b><br>OMB0164 | Power: 500 N | Speed: 140 s | Stroke length: 5,5 mm | Consumption: 3,5 VA 230 VAC   | <b>A2</b> | 185 |
|  | <b>NRD230-3-HW</b><br>OMB0602 | Power: 500 N | Speed: 35 s  | Stroke length: 6,5 mm | Consumption: 2,5 VA 230 VAC   | <b>A2</b> | 207 |
|  | <b>NRD24-3-HW</b><br>OMB0603  | Power: 400 N | Speed: 35 s  | Stroke length: 6,5 mm | Consumption: 3 VA 24 VAC /DC  | <b>A2</b> | 207 |
|  | <b>NRD24-3-HW</b><br>OMB0599  | Power: 500 N | Speed: 140 s | Stroke length: 6,5 mm | Consumption: 3 VA 24 VAC / DC | <b>A2</b> | 185 |
|  | <b>NRD230-3-HW</b><br>OMB0598 | Power: 500 N | Speed: 140 s | Stroke length: 6,5 mm | Consumption: 3,5 VA 24 VAC    | <b>A2</b> | 185 |

## HT AND HR... VALVE ACTUATORS

Suitable for R2-, R3- and R4..D(K) ball valves

Applications: For heating, domestic hot water and ventilation



\*)

|   |                            |             |              |                                 |           |     |
|---|----------------------------|-------------|--------------|---------------------------------|-----------|-----|
| ! | <b>HTC24-3</b><br>OMB0071  | Power: 5 Nm | Speed: 70 s  | Consumption: 1,5 VA 24 VAC / DC | <b>A2</b> | 201 |
| ! | <b>HTC230-3</b><br>OMB0074 | Power: 5 Nm | Speed: 70 s  | Consumption: 2,5 VA 230 VAC     | <b>A2</b> | 201 |
|   | <b>HTD24-3</b><br>OMB0075  | Power: 5 Nm | Speed: 140 s | Consumption: 1,5 VA 24 VAC / DC | <b>A2</b> | 194 |
|   | <b>HTYD24-3</b><br>OMB0078 | Power: 5 Nm | Speed: 35 s  | Consumption: 1,5 VA 24 VAC / DC | <b>A2</b> | 194 |

! no stock product

# 0 - 10 V controlled actuators

Price EUR  
Vat 0%

## M41A15 VALVE ACTUATOR, IP54

Suitable for valves with 6,5 mm stroke length.

Applications: For heating regulation in district heating exchangers and boiler plants, for cooling circuit regulation.



\*)

|                          |   |           |     |
|--------------------------|---|-----------|-----|
| <b>M41A15</b><br>OMA0207 | Valve actuator, 0(2)...10 VDC controlled. 24 V, 50 Hz, 5 VA. Speed 15 s/6,5 mm. Power 400 Nm. | <b>A3</b> | 308 |
|--------------------------|---|-----------|-----|

## M31A150 VALVE ACTUATOR, IP42

Suitable for valves with 6,5 mm stroke length.

Applications: For heating and ventilation.



\*)

|                           |   |           |     |
|---------------------------|---|-----------|-----|
| <b>M31A150</b><br>OMA0205 | Valve actuator, 0(2)...10 VDC controlled. 24 V, 50 Hz, 1,7 VA, Speed 150s/6,5 mm. Power 300 Nm. Connection cable 1,5 m. | <b>A3</b> | 215 |
|---------------------------|---|-----------|-----|

## M7410E... VALVE ACTUATORS, IP43

Applications: Heating- and ventilation systems

- Suitable for valves with 6,5 mm stroke length.
- Connection cable 1,5 m



\*)

|                             |   |           |     |
|-----------------------------|---|-----------|-----|
| <b>M7410E1002</b><br>HON016 | Valve actuator, no manual use, 0(2)...10 VDC controlled. 24 V, 50 Hz, 1,7 VA. Speed 150 s/6,5 mm. Power 180 Nm. | <b>A3</b> | 428 |
| <b>M7410E1028</b><br>HON017 | Valve actuator, no manual use, 0(2)...10 VDC controlled. 24 V, 50 Hz, 1,7 VA. Speed 150 s/6,5 mm. Power 300 Nm. | <b>A3</b> | 422 |
| <b>M7410E2026</b><br>HON018 | Valve actuator, 0(2)...10 VDC controlled. 24 V, 50 Hz, 1,7 VA. Speed 150 s/6,5 mm. Power 180 Nm.                | <b>A3</b> | 382 |
| <b>M7410E2034</b><br>HON019 | Valve actuator, 0(2)...10 VDC controlled. 24 V, 50 Hz, 1,7 VA. Speed 150 s/6,5 mm. Power 300 Nm.                | <b>A3</b> | 522 |

## ML7420A... VALVE ACTUATORS, IP54

Suitable for valves with 20 mm stroke length.

Power 600 Nm

Applications: For heating, domestic hot water and ventilation



\*)

|                              |   |           |     |
|------------------------------|---|-----------|-----|
| <b>ML7420A6009</b><br>HON032 | Valve actuator, 0(2)...10 VDC controlled. 24 V, 50 Hz, 5 VA, speed 60s/20mm. Analog output of 2-10 VDC. | <b>A3</b> | 620 |
| <b>ML7420A6017</b><br>HON237 | Valve actuator, 0(2)...10 VDC controlled. 24 V, 50 Hz, 7 VA, speed 30s/20mm. Analog output of 2-10 VDC. | <b>A3</b> | 636 |

## ML7421... VALVE ACTUATORS, IP54

Applications: For heating

Power 1800 Nm



\*)

|                              |   |           |      |
|------------------------------|---|-----------|------|
| <b>ML7421A3004</b><br>HON034 | Valve actuator, 0(2)...10 VDC controlled. , 24 V, 50 Hz, 14 VA, speed 114s/20mm. Analog output of 2-10 VDC. | <b>A3</b> | 984  |
| <b>ML7421B3003</b><br>HON035 | Valve actuator, 0(2)...10 VDC controlled. , 24 V, 50 Hz, 14 VA, speed 210s/38mm. Analog output of 2-10 VDC. | <b>A3</b> | 1509 |

! no stock product

\*) We reserve the right to change the prices according to Honeywell.

# 0 - 10 V controlled actuators

Price EUR  
Vat 0%

## ML7425... VALVE ACTUATORS, IP54

Applications: Heating systems

- Suitable for valves with 20 mm stroke length.
- Power 600 Nm



\*)

|   |                              |  |           |      |
|---|------------------------------|--|-----------|------|
| ! | <b>ML7425A6008</b><br>HON036 | Valve actuator, 0(2)...10 VDC controlled. 24 V, 50 Hz, 12 VA, speed 108s/20mm. 12s spring. Spring return out. Analog output of 2-10 VDC. | <b>A3</b> | 1241 |
| ! | <b>ML7425B6007</b><br>HON037 | Valve actuator, 0(2)...10 VDC controlled. 24 V, 50 Hz, 12 VA, speed 108s/20mm. 12s spring. Spring return in. Analog output of 2-10 VDC.  | <b>A3</b> | 1488 |

## MVN... VALVE ACTUATOR, IP40

- Used with control ball valve (VBGx)



\*)

|   |                              |   |           |     |
|---|------------------------------|---|-----------|-----|
| ! | <b>MVN713A1500</b><br>HON040 | Valve actuator, 0(2)...10 VDC controlled, 24 V, 50 Hz, 5 VA, Speed 90s/90°. Power 3 Nm. | <b>A3</b> | 285 |
|---|------------------------------|---|-----------|-----|

## HTC24-SR VALVE ACTUATOR

Connection cable 1 m. The control voltage 0 (2) -10 V. Suitable with WNR-adaptor for R-series ball valves and with MS-NRE6-adaptor for Esben VRG and VRB valves.

Applications: For heating



\*)

|                             |             |              |  |                               |           |     |
|-----------------------------|-------------|--------------|--|-------------------------------|-----------|-----|
| <b>HTC24-SR</b><br>OMB0072  | Power: 5 Nm | Speed: 70 s  |  | Consumption: 3 VA 24 VAC / DC | <b>A2</b> | 239 |
| <b>HTD24-SR</b><br>OMB0076  | Power: 5 Nm | Speed: 140 s |  | Consumption: 3 VA 24 VAC / DC | <b>A2</b> | 239 |
| <b>HTYD24-SR</b><br>OMB0079 | Power: 5 Nm | Speed: 35 s  |  | Consumption: 3 VA 24 VAC / DC | <b>A2</b> | 259 |

## NR... VALVE ACTUATOR

Applications: For heating, domestic hot water and ventilation



\*)

|                               |              |              |                      |                                 |           |     |
|-------------------------------|--------------|--------------|----------------------|---------------------------------|-----------|-----|
| <b>NRD24-SR-SI</b><br>OMB0170 | Power: 500 N | Speed: 35 s  | Stroke length 5,5 mm | Consumption: 3 VA 24 VAC / DC   | <b>A2</b> | 301 |
| <b>NRD24-SR-HW</b><br>OMA0221 | Power: 500 N | Speed: 35 s  | Stroke length 6,5 mm | Consumption: 3 VA 24 VAC / DC   | <b>A2</b> | 301 |
| <b>NRD24-SR-HW</b><br>OMB0601 | Power: 500 N | Speed: 17 s  | Stroke length 6,5 mm | Consumption: 2,5 VA 24 VAC / DC | <b>A2</b> | 324 |
| <b>NRD24-SR-HW</b><br>OMB0600 | Power: 500 N | Speed: 140 s | Stroke length 6,5 mm | Consumption: 1,5 VA 24 VAC / DC | <b>A2</b> | 279 |

## ADAPTERS FOR VALVE ACTUATORS

|                           |  |           |    |
|---------------------------|--|-----------|----|
| <b>MS-NRE</b><br>OMB0142  | Adapter for the valves Esbe and Termomix   | <b>A2</b> | 14 |
| <b>MS-NRE6</b><br>OMB0144 | Adapter for the valves: VRG, VRB           | <b>A2</b> | 14 |
| <b>WNR</b><br>OMC0180     | Adapter between NR-actuator and ball valve | <b>A2</b> | 25 |

! no stock product

# Damper actuators

Price EUR  
Vat 0%

## Honeywell damper actuators

- Suitable for all sizes of shafts
- Very easy to install and connect
- Does not require separate casing for power supply

### N05... ja N10... DAMPER ACTUATORS, IP54

- 5 Nm for 1 m<sup>2</sup> dampers
- 10 Nm for 2 m<sup>2</sup> dampers



\*)

|                              |  |           |     |
|------------------------------|--|-----------|-----|
| <b>N05010</b><br>HON228      | Damper actuator, 0(2)...10 VDC controlled, 24 VDC/ac, 50 Hz, 5 VA, speed 90/110s. Power 5 Nm. Analog output of 2-10 VDC.   | <b>A3</b> | 228 |
| <b>N05010-SW2</b><br>HON041  | Damper actuator, 0(2)...10 VDC controlled, 24 VDC/ac, 50 Hz, 5 VA, speed 90/110s. Power 5 Nm. Analog output of 2-10 VDC. 2 pcs micro switches ready for serial control.  | <b>A3</b> | 495 |
| <b>N05230-2POS</b><br>HON042 | Damper actuator, 2-point control, 230 VAC, 50 Hz, 22 VA, speed 110s. Power 5 Nm.   | <b>A3</b> | 283 |
| <b>N0524</b><br>HON314       | Damper actuator, 2- and 3-point control, 24 VDC/ac, 50 Hz, 5 VA, speed 110s. Power 5 Nm.   | <b>A3</b> | 316 |
| <b>N0524-SW2</b><br>HON043   | Damper actuator, 2- and 3-point control, 24 VDC/ac, 50 Hz, 5 VA, speed 110s. Power 5 Nm. 2 pcs micro switches ready for serial control.                                  | <b>A3</b> | 328 |
| <b>N10010</b><br>HON315      | Damper actuator, 0(2)...10 VDC controlled, 24 VDC/ac, 50 Hz, 5 VA, speed 90/110s. Power 10 Nm. Analog output of 2-10 VDC.  | <b>A3</b> | 514 |
| <b>N10010-SW2</b><br>HON044  | Damper actuator, 0(2)...10 VDC controlled, 24 VDC/ac, 50 Hz, 5 VA, speed 90/110s. Power 10 Nm. Analog output of 2-10 VDC. 2 pcs micro switches ready for serial control. | <b>A3</b> | 551 |
| <b>N10230-2POS</b><br>HON045 | Damper actuator, 2-point control, 230 VAC, 50 Hz, 22 VA, speed 140s. Power 10 Nm.  | <b>A3</b> | 385 |
| <b>N1024</b><br>HON316       | Damper actuator, 2- and 3-point control, 24 VDC/ac, 50 Hz, 5 VA, speed 110s. Power 10 Nm.  | <b>A3</b> | 349 |
| <b>N1024-SW2</b><br>HON046   | Damper actuator, 2- and 3-point control, 24 VDC/ac, 50 Hz, 5 VA, speed 110s. Power 10 Nm. 2 pcs micro switches ready for serial control.                                 | <b>A3</b> | 382 |

### N20... DAMPER ACTUATORS, IP54

- For 4 m<sup>2</sup> dampers
- Power 20 Nm



\*)

|                             |   |           |     |
|-----------------------------|---|-----------|-----|
| <b>N20010</b><br>HON317     | Damper actuator, 0(2)...10 VDC controlled, 24 VDC/ac, 50 Hz, 6 VA, speed 95/110s. Analog output of 2-10 VDC.  | <b>A3</b> | 597 |
| <b>N20010-SW2</b><br>HON047 | Damper actuator, 0(2)...10 VDC controlled, 24 VDC/ac, 50 Hz, 6 VA, speed 95/110s. Analog output of 2-10 VDC. 2 pcs micro switches ready for serial control. | <b>A3</b> | 693 |
| <b>N20230</b><br>HON048     | Damper actuator, 2- and 3-point control, 230 VAC, 50 Hz, 8 VA, speed 110s.  | <b>A3</b> | 427 |
| <b>N20230-SW2</b><br>HON049 | Damper actuator, 2- and 3-point control, 230 VAC, 50 Hz, 8 VA, speed 110s. 2 pcs micro switches ready for serial control.                                   | <b>A3</b> | 461 |
| <b>N2024</b><br>HON318      | Damper actuator, 2- and 3-point control, 24 VDC/ac, 50 Hz, 6 VA, speed 110s. Voima 20 Nm.   | <b>A3</b> | 464 |
| <b>N2024-SW2</b><br>HON050  | Damper actuator, 2- and 3-point control, 24 VDC/ac, 50 Hz, 6 VA, speed 110s. 2 pcs micro switches ready for serial control.                                 | <b>A3</b> | 454 |

### N34... DAMPER ACTUATORS, IP54

- For 6 m<sup>2</sup> dampers
- Power 34 Nm



\*)

|                         |  |           |     |
|-------------------------|--|-----------|-----|
| <b>N34010</b><br>HON051 | Damper actuator, 0(2)...10 VDC controlled, 24 VDC/ac, 50 Hz, 6 VA, speed 95/110s. Analog output of 2-10 VDC. | <b>A3</b> | 777 |
| <b>N34230</b><br>HON052 | Damper actuator, 2- and 3-point control, 230 VAC, 50 Hz, 13 VA, speed 110s.                                  | <b>A3</b> | 765 |

! no stock product

# Damper actuators

Price EUR  
Vat 0%

## S03 / S05... DAMPER ACTUATORS, IP54

- Spring return 25 s
- 3 Nm for 0,6 m<sup>2</sup> dampers
- 5 Nm for 1m<sup>2</sup> dampers



\*)

|                                  |   |           |     |
|----------------------------------|---|-----------|-----|
| <b>S03010</b><br>HON319          | Damper actuator, 0(2)...10 VDC controlled, 24 VDC/ac, 50 Hz, 7 VA, speed 90s. Power 3 Nm. Analog output of 2-10 VDC.                                | <b>A3</b> | 357 |
| <b>S0524-2POS</b><br>HON321      | Damper actuator, 2-point control, 24 VDC/ac, 50 Hz, 8 VA, speed 45s. Power 5 Nm.  | <b>A3</b> | 490 |
| <b>S0524-2POS-SW1</b><br>HON062  | Damper actuator, 2-point control, 24 VDC/ac, 50 Hz, 8 VA, speed 45s. Power 5 Nm. 1 pcs adjustable micro switch.                                     | <b>A3</b> | 465 |
| <b>S05010</b><br>HON058          | Damper actuator, 0(2)...10 VDC controlled, 24 VDC/ac, 50 Hz, 8 VA, speed 90s. Power 5 Nm. Analog output of 2-10 VDC.                                | <b>A3</b> | 573 |
| <b>S05010-SW1</b><br>HON059      | Damper actuator, 0(2)...10 VDC controlled, 24 VDC/ac, 50 Hz, 8 VA, speed 90s. Power 5 Nm. Analog output of 2-10 VDC. 1 pcs adjustable micro switch. | <b>A3</b> | 459 |
| <b>S05230-2POS</b><br>HON060     | Damper actuator, 2-point control, 230 VAC, 50 Hz, 14 VA, speed 45s. Power 5 Nm.   | <b>A3</b> | 322 |
| <b>S05230-2POS-SW1</b><br>HON061 | Damper actuator, 2-point control, 230 VAC, 50 Hz, 14 VA, speed 45s. Power 5 Nm. 1 pcs adjustable micro switch.                                      | <b>A3</b> | 419 |

## S10... ja S20... DAMPER ACTUATORS, IP54

- Spring return 20 s
- 10 Nm for 1,5 m<sup>2</sup> dampers
- 20 Nm for 4,6 m<sup>2</sup> dampers



\*)

|                                  |   |           |     |
|----------------------------------|---|-----------|-----|
| <b>S10010</b><br>HON322          | Damper actuator, 0(2)...10 VDC controlled, 24 VDC/ac, 50 Hz, 14 VA, speed 90s. Power 10 Nm. Analog output of 2-10 VDC.  | <b>A3</b> | 671 |
| <b>S10010-SW2</b><br>HON063      | Damper actuator, 0(2)...10 VDC controlled, 24 VDC/ac, 50 Hz, 14 VA, speed 90s. Power 10 Nm. Analog output of 2-10 VDC. 2 pcs micro switches ready for serial control. | <b>A3</b> | 511 |
| <b>S1024-2POS</b><br>HON324      | Damper actuator, 2-point control, 24 VDC/ac, 50 Hz, 30 VA, speed 45s. Power 10 Nm.  | <b>A3</b> | 496 |
| <b>S1024-2POS-SW2</b><br>HON065  | Damper actuator, 2-point control, 24 VDC/ac, 50 Hz, 30 VA, speed 45s. Power 10 Nm. 2 pcs micro switches ready for serial control.                                     | <b>A3</b> | 422 |
| <b>S10230-2POS</b><br>HON323     | Damper actuator, 2-point control, 230 VAC, 50 Hz, 45 VA, speed 45s. Power 10 Nm.  | <b>A3</b> | 551 |
| <b>S10230-2POS-SW2</b><br>HON067 | Damper actuator, 2-point control, 230 VAC, 50 Hz, 45 VA, speed 45s. Power 10 Nm. 2 pcs micro switches ready for serial control.                                       | <b>A3</b> | 730 |
| <b>S20010</b><br>HON325          | Damper actuator, 0(2)...10 VDC controlled, 24 VDC/ac, 50 Hz, 16VA, speed 90s. Power 20 Nm. Analog output of 2-10 VDC.   | <b>A3</b> | 938 |
| <b>S20010-SW2</b><br>HON066      | Damper actuator, 0(2)...10 VDC controlled, 24 VDC/ac, 50 Hz, 16VA, speed 90s. Power 20 Nm. Analog output of 2-10 VDC. 2 pcs micro switches ready for serial control.  | <b>A3</b> | 864 |
| <b>S2024-2POS</b><br>HON327      | Damper actuator, 2-point control, 24 VDC/ac, 50 Hz, 45 VA, speed 45s. Power 20 Nm.  | <b>A3</b> | 717 |
| <b>S2024-2POS-SW2</b><br>HON068  | Damper actuator, 2-point control, 24 VDC/ac, 50 Hz, 45 VA, speed 45s. Power 20 Nm. 2 pcs micro switches ready for serial control.                                     | <b>A3</b> | 536 |
| <b>S20230-2POS</b><br>HON326     | Damper actuator, 2-point control, 230 VAC, 50 Hz, 60 VA, speed 45s. Power 20 Nm.  | <b>A3</b> | 836 |
| <b>S20230-2POS-SW2</b><br>HON067 | Damper actuator, 2-point control, 230 VAC, 50 Hz, 60 VA, speed 45s. Power 20 Nm. 2 pcs micro switches ready for serial control.                                       | <b>A3</b> | 730 |

! no stock product



# Damper actuators

Price EUR  
Vat 0%

## NM..A DAMPER ACTUATOR, IP 54

- 10 Nm
- For 2 m2 dampers
- The drive time 150 s



\*)

|   |                            |                               |              |                               |           |     |
|---|----------------------------|-------------------------------|--------------|-------------------------------|-----------|-----|
| ! | <b>NM24A</b><br>OMB0158    | 3-point control / open-closed | Power: 10 Nm | Consumption: 4 VA 24 VAC / DC | <b>A2</b> | 192 |
| ! | <b>NM230A</b><br>OMB0157   | 3-point control / open-closed | Power: 10 Nm | Consumption: 6 VA 230 VAC     | <b>A2</b> | 198 |
| ! | <b>NM24A-SR</b><br>OMB0159 | 2-10 V-control                | Power: 10 Nm | Consumption: 4 VA 24 VAC / DC | <b>A2</b> | 274 |

## SM..A DAMPER ACTUATOR, IP 54

- 20 Nm
- For 4 m2 dampers
- The drive time 150 s



\*)

|   |                            |                               |              |                               |           |     |
|---|----------------------------|-------------------------------|--------------|-------------------------------|-----------|-----|
| ! | <b>SM24A</b><br>OMB0385    | 3-point control / open-closed | Power: 20 Nm | Consumption: 4 VA 24 VAC / DC | <b>A2</b> | 222 |
| ! | <b>SM230A</b><br>OMB0384   | 3-point control / open-closed | Power: 20 Nm | Consumption: 6 VA 230 VAC     | <b>A2</b> | 227 |
| ! | <b>SM24A-SR</b><br>OMB0386 | 2-10 V-control                | Power: 20 Nm | Consumption: 4 VA 24 VAC / DC | <b>A2</b> | 309 |

## NF... DAMPER ACTUATOR

- 10 Nm
- For 2 m2 dampers
- The drive time 75 s, NF24A-SR 150 s
- Spring return 20 s



\*)

|  |                            |                     |              |                                 |           |     |
|--|----------------------------|---------------------|--------------|---------------------------------|-----------|-----|
|  | <b>NF24A</b><br>OMB0155    | Open-closed control | Power: 10 Nm | Consumption: 5,5 VA 24 VAC / DC | <b>A2</b> | 312 |
|  | <b>NF24A-SR</b><br>OMB0156 | Control 2...10 V    | Power: 10 Nm | Consumption: 5,5 VA 24 VAC / DC | <b>A2</b> | 368 |

## SF... DAMPER ACTUATOR, IP 54

- 15 Nm
- For 4 m2 dampers
- The drive time 75 s, SF24A-SR 150 s
- Spring return 20 s



\*)

|  |                            |                |              |   |           |     |
|--|----------------------------|----------------|--------------|---|-----------|-----|
|  | <b>SF24A</b><br>OMB0377    | Open-closed    | Power: 20 Nm | Consumption: 7,5 VA 24 VAC / DC           | <b>A2</b> | 382 |
|  | <b>SFA</b><br>OMB0376      | Open-closed    | Power: 20 Nm | Consumption: 18 VA 24-240 VAC/ 24-125 VDC | <b>A2</b> | 438 |
|  | <b>SF24A-SR</b><br>OMB0378 | 2-10 V-control | Power: 20 Nm | Consumption: 7 VA 24 VAC / DC             | <b>A2</b> | 438 |

! no stock product

\*) We reserve the right to change the prices according to Belimo

## Other field devices

Price EUR  
Vat 0%

### C01A THERMOSTAT



|                        |  |           |           |
|------------------------|--|-----------|-----------|
| <b>C01A</b><br>OMA0043 | Thermostat, surface mounting 20...90 °C, differential range 7 °C | <b>A2</b> | <b>74</b> |
|------------------------|--|-----------|-----------|

### JVA24 FROST PROTECTION THERMOSTAT

JVA 24 is security component, which monitors and adjusts AHU's water radiator return temperature if needed. It is designed to prevent freezing of water radiator. Suitable sensors Ouman TMI Pt 1000 and Ni 1000.



|                         |  |           |            |
|-------------------------|--|-----------|------------|
| <b>JVA24</b><br>OMB0107 | Anticipating frost protection thermostat | <b>A2</b> | <b>201</b> |
|-------------------------|--|-----------|------------|

### EHC VOLTAGE DIVIDER

- Operating voltage 24 VAC
- Input 0-10 VDC
- Output 0-10 V / 10-0 V



|                       |                 |           |           |
|-----------------------|-----------------|-----------|-----------|
| <b>EHC</b><br>OMA0148 | Voltage divider | <b>A1</b> | <b>87</b> |
|-----------------------|-----------------|-----------|-----------|

### EHR VOLTAGE-CONTROLLED RELAY, IP 55

- Operating voltage 24 VAC
- Input 0 - 10 V
- 2 pcs output, exchange contact 8 (1) A / 230 VAC



|                       |                          |           |           |
|-----------------------|--------------------------|-----------|-----------|
| <b>EHR</b><br>OMA0154 | Voltage-controlled relay | <b>A1</b> | <b>94</b> |
|-----------------------|--------------------------|-----------|-----------|

### TI DUCT THERMOMETER Ø 100 MM

- Length 200 mm
- Temperature range -40 °C ... +60 °C



|                      |                  |           |           |
|----------------------|------------------|-----------|-----------|
| <b>TI</b><br>OMB0399 | Duct thermometer | <b>A2</b> | <b>22</b> |
|----------------------|------------------|-----------|-----------|

## Other field devices

Price EUR  
Vat 0%

### ETT6 INDULGE BUTTON

- 1...6 hours extra running time for the device by pressing the button.



\*)

|                        |                |           |            |
|------------------------|----------------|-----------|------------|
| <b>ETT6</b><br>OMB0516 | Indulge button | <b>A2</b> | <b>112</b> |
|------------------------|----------------|-----------|------------|

### PWR POWER UNITS

- Four different outputs power source.



|                              |   |           |    |
|------------------------------|---|-----------|----|
| <b>PWR 10</b><br>OMB0489     | Power unit 24 VAC / 10 VA, width 35,5 mm (2M) | <b>C2</b> | 23 |
| <b>PWR 24</b><br>OMB0488     | Power unit 24 VAC / 24 VA, width 54 mm (3M)   | <b>C2</b> | 26 |
| <b>PWR 40</b><br>OMB0486     | Power unit 24 VAC / 40 VA, width 54 mm (3M)   | <b>C2</b> | 36 |
| <b>PWR 63</b><br>OMB0487     | Power unit 24 VAC / 63 VA, width 106 mm (6M)  | <b>C2</b> | 54 |
| <b>PWR 24V/1A</b><br>OMB0522 | Power unit 24VDC/1A, width 35 mm (2M)         | <b>C2</b> | 26 |

### VAK-POWER UNITS



|                          |  |           |    |
|--------------------------|--|-----------|----|
| <b>PWR130</b><br>OMB0425 | Protective voltage transformer with thermal prot. 230VAC / 24 VAC, 130 VA.<br>DIN-rail mounting W90,L84,H110 | <b>C2</b> | 43 |
| <b>PWR180</b><br>OMB0426 | Protective voltage transformer with thermal prot. 230VAC / 24 VAC, 180 VA. W105,L89,H115                     | <b>C2</b> | 58 |
| <b>PWR250</b><br>OMB0427 | Protective voltage transformer with thermal prot. 230VAC / 24 VAC, 250 VA. W130, L115, H119                  | <b>C2</b> | 73 |

# Ouman Oy - General Terms of Delivery and Warranty

## SCOPE OF APPLICATION

These Terms of Delivery shall apply to any retail of components and equipment between Ouman Oy and the customer, unless other agreements are signed (excluding deliveries involving customised products or deliveries that involve a significant amount of installation).

## PRICING

Pricing is based on Ouman Oy's pricelist valid on the day the order is placed. All prices are indicated without value added tax. The taxes are calculated according to the prevailing legislation. In the event that any changes take place in payments related to customs, freight, VAT or other general payments before the date of delivery, the seller shall have the right to adjust the pricing of the articles in the same proportion as the changed pricing or payments have impacted the price of the articles.

## OFFER

The price indicated in the offer is a net price for a given unit (excluding VAT) for the indicated quantity located in the seller's warehouse. Any offer provided by the seller is binding and valid for 30 days, unless otherwise indicated. If the seller's offer is subject to goods still remaining unsold at the time of buyer's order, the goods can be sold to a third party during the period of the offer and the seller does not guarantee that there is stock.

## AGREEMENT

An agreement is formed between the seller and the buyer once the parties to the agreement have signed a written agreement (Procurement Agreement); the buyer has, in writing or verbally, agreed a binding agreement (order), or the seller has, in writing or verbally, confirmed an order, which is not based on an offer or differs from an offer, per se (order confirmation).

## DIAGRAMS AND DESCRIPTIONS

Any price, measurement, weight and performance-related information indicated in descriptions, figures, diagrams, lists and pricelists are provided without guarantees, unless the offer specifically refers to such information. Any drawings and technical documents required for the manufacturing of the goods or their components, delivered, prior to or after entering into an agreement, from one party to another party to an agreement, shall remain in the possession of the supplier. The recipient shall not have the right to use, duplicate, deliver or otherwise provide any related information to a third party.

## TERMS OF DELIVERY

The terms of delivery is FCA (Incoterms 2010), unless other agreements are signed.

## PACKAGE

Any prices indicated in the pricelists and catalogues refer to unpacked goods.

## DELIVERY TIME

The seller shall deliver the goods as agreed. In the event that no delivery time is agreed upon, the seller shall deliver the ordered products immediately, or as soon as stock is available. In the event that the seller has receivables due from the buyer, the seller, after informing the buyer, shall have the right to delay agreed deliveries until due payments are remitted. In such event it is considered that the agreed delivery time is delayed accordingly, and the buyer shall not have the right to make claims related to such delay. The goods are considered to be delivered once they are dispatched or reported as ready for delivery and the buyer is contractually obligated to retrieve the goods from the seller or from a location indicated by the seller.

## DELAY NOTIFICATIONS

The buyer and the seller must immediately inform one another in the event that a delivery or reception of delivery may be delayed. Once either party receives notification of a delay, they must immediately inform the other party, stating the reason for the delay and the estimated new delivery date.

## DELIVERY AND INSPECTION OF GOODS

Liability for risk is transferred to the buyer upon delivery of the goods. The goods must be equipped with a delivery note. Upon receiving the delivery, the buyer must confirm that the delivery is in accordance with the order and the delivery note and free of external damages. The goods must be appropriately inspected by the buyer once more before commissioning, mounting or installation. Any reclamation related to quantities or type of goods shall be done in writing within 8 business days of receipt of goods. Failure to do so will void the buyer's right to claims related to deficiencies or inadequacies.

# Ouman Oy - General Terms of Delivery and Warranty

## **FORCE MAJEURE**

The seller is not obligated to fulfil their contractual obligations in the event of a force majeure, or if the fulfilment of the contractual obligations would require sacrifices that are disproportionate in terms of the resulting benefit to the buyer. In the event that the force majeure ceases within a reasonable timeframe, the buyer shall have the right to demand the seller to meet their contractual obligations. In the event that the manufacturer or supplier, who the seller has procured the goods from, neglects their contractual obligations, resulting in a delay in a delivery by the seller, the seller shall not be liable for damages incurred by the buyer in such event. If the seller is affected by a force majeure described herein, the buyer shall not have the right to demand a new delivery to replace defective goods. In the event that the fulfilment of contractual obligations within a reasonable timetable is impossible due to a force majeure, both parties to the agreement shall have the right, without incurred liability, to terminate the agreement by notifying the other party in writing.

## **PAYMENT**

Payment term begins from the date of the invoice. In the event that a payment is delayed, the buyer shall be liable to pay interest on overdue payments according to the current interest rates applied by the seller, as well as any costs resulting from the recovery of overdue payments.

## **WARRANTY**

The seller provides a 24-month warranty for the quality of the materials and workmanship of all delivered goods. The warranty period begins on the date of purchase. In the event that material or workmanship defects are detected and the goods are sent, without delay or no later than by the end of the warranty period, back to the seller, the seller agrees to address the defect at their own discretion either by repairing the damaged goods or by delivering a new, defect-free goods, free of charge, to the buyer. The buyer is responsible for the costs resulting from delivering the goods to the seller for warranty repairs, while the seller is responsible for the costs resulting from returning the goods to the buyer. The warranty shall not cover damages resulting from accidents, lightning, floods or other natural events, normal wear and tear, inappropriate, negligent or unusual use of the goods, overloading, incorrect maintenance, or reconstruction, alteration and installation work which is not carried out by the seller (or their authorised representative). The buyer shall be responsible for selecting material of equipment susceptible to corrosion, unless other agreements are signed. In the event that the seller alters the structure of their equipment, they shall not be obligated to make similar changes to previously procured equipment. The validity of the warranty requires that the buyer has fulfilled their contractual obligations related to the delivery. The seller shall provide a new warranty for goods replaced or repaired under the original warranty. However, the new warranty shall only be valid until the expiration of the warranty period of the original goods. For any repairs not covered by the warranty shall be subject to a 3-month maintenance warranty covering the material and workmanship.

## **INDIRECT DAMAGES**

The seller shall not be liable for any indirect damages incurred by the buyer as a result of delays or inadequacies related to the delivery. Furthermore, the seller shall not be liable for indirect damages resulting from a defective product in the event that the defect is caused by damages indicated in the warranty section as not covered by the warranty. Subject to the terms of the product liability insurance, the seller's insurance company shall reimburse any indirect material damages or physical injuries resulting from a defective product, provided that the defect could not be discovered at the factory under normal testing conditions.

## **RETURNS**

The transaction is binding and irreversible, and the seller shall not be obligated to accept any product returns. In the event, however, that the seller as explicitly agreed to a return, any goods delivered under this agreement shall be received and reimbursed up to 70% of the retail price. Such goods can only be received and reimbursed in the event that they are returned in the original packing and condition.

## **NOTIFICATIONS**

The sender is responsible for ensuring that notifications sent to the other party are delivered.

## **OWNERSHIP**

The ownership of the goods is transferred to the buyer upon remittance of the entire purchase price.

## **DISAGREEMENTS**

Any disagreements resulting from the agreements and their terms should be primarily resolved through bilateral negotiations. In the event that the disagreement cannot be resolved, the disagreement shall be resolved through arbitration in Finland according to current legislation. The arbitration court consists of one (1) member.

## The factory and sales office



Linnunrata 14, 90440 KEMPELE

## Southern Finland sales office



Itsehallintokuja 6, 02600 ESPOO

## General web addresses

<https://oumanshop.com>

<https://ouman.fi>

[sales@ouman.fi](mailto:sales@ouman.fi)

## Export

### KARI HEIKKILÄ

Export Manager  
Building Automation  
Tel. +358 40 840 2312  
[kari.heikkila@ouman.fi](mailto:kari.heikkila@ouman.fi)



### JILSON UKKAN

Technical Support Specialist  
Building Automation  
Tel. +372 5391 2558  
[jilson.ukkan@ouman.ee](mailto:jilson.ukkan@ouman.ee)



### ALEKSANDER LIIN

Area Sales Manager - Baltics  
Building Automation  
Tel. +372 5349 4605  
[aleksander.liin@ouman.ee](mailto:aleksander.liin@ouman.ee)



## Sweden

### J MARTIN GRÄNNSJÖ

Senior Technician

Tel. +46 31 939 176  
[jmartin.grannsjö@ouman.se](mailto:jmartin.grannsjö@ouman.se)



We reserve the right to make changes and corrections in prices, products, and specifications without notice.